



PUBLIC ART OPPORTUNITY

Invitation to Submit Qualifications

Posted December 19, 2019

Lambert Art & Culture Program

Major Albert Bond Lambert Legacy Glass Project

St. Louis Lambert International Airport (“the Airport”), owned and operated by the City of St. Louis, is seeking qualifications from artists to create a unique two-dimensional glass artwork that celebrates the life and legacy of Major Albert Bond Lambert on the 100th anniversary of the airport he founded.

Artist design fee: \$10,000 (separate budget for fabrication and installation)

Qualifications will be reviewed by the Airport Art Advisory Committee (AAAC) and one artist will be recommended to create a concept proposal for the artwork. The submission requirements are described below. Qualifications are due February 3, 2020.

BACKGROUND

About St. Louis Lambert International Airport

Major Albert Bond Lambert, a World War I veteran and student of the Wright brothers, first leased 170 acres of Missouri farmland in 1920. The land was initially used for hot air balloon flights, a National Guard base, mail delivery, air races, and even early transcontinental flight. Lambert later bought the field and then sold it to the City of St. Louis in 1928, to establish one of the first municipally-owned airports in the country. More about the life of Lambert can be found [here: \[http://missourilegends.com/missouri-business-legends/albert-lambert/\]](http://missourilegends.com/missouri-business-legends/albert-lambert/)

Throughout its history, the Airport has influenced significant aviation milestones: Charles Lindbergh; impact on the Space Race through the growth of the McDonnell Douglas Corporation (later Boeing); and the historic Minoru Yamasaki-designed Terminal. The Airport continues to meet the ever-changing challenges of air travel and the aviation industry, connecting the St. Louis region to the world for nearly a century and thinking innovatively into the future.

About the Lambert Art and Culture Program

The Lambert Art and Culture Program (LACP) builds upon the culturally rich legacy of St. Louis Lambert International Airport. Our mission is to elevate the visitor experience and uplift regional pride through the presentation of artwork created by local, national, and international artists.

Lambert Art and Culture Program Goals:

- Feature the best local, national and international talent.
- Enhance gathering places for airport customers.
- Complement and build upon the established visual identity of the airport.
- Generate community pride while inspiring joy and wonder.
- Create a visually outstanding impression of St. Louis.
- Endure multiple visits to the airport.

The LACP grew out of the 2008 Airport Experience Program, a major renovation project to improve the Airport's operations and pay tribute to the building's iconic architecture and historic role as a civic space and landmark. Beginning in 2011, artist Alicia LaChance was selected to design a terrazzo floor medallion that is located just past the Concourse C security checkpoint. In addition, nine St. Louis based visual artists (Lauren F. Adams, Sarah Giannobile, Joan Hall, Jana Harper, Tom Huck, William LaChance, Eva Lundsager, Edna Patterson Petty, Mel Watkin) were commissioned to create work that was translated in art glass screens and installed throughout the A and C Concourses. These nine glass screens will serve as a model for the scale, structure and technique used for the Lambert Legacy Glass Project in order to maintain a consistent visual language throughout the terminal.

For more information about the LACP visit www.artoftravelstl.com.

About the Legacy Glass Project

The Legacy Glass Project should commemorate the life and legacy of Major Albert Bond Lambert and his contribution to the history of flight and the Airport. Historical images, information and contact with a historian expert will be provided to the selected artist in order to assist them in creating a commemorative artwork for Major Albert Bond Lambert.

Legacy Glass Project Goals:

- Celebrate the contribution of Albert Bond Lambert to the creation of the Airport for the 100th anniversary.
- Share the story of innovation and forward-thinking that led Lambert to begin the Airport through a contemporary, artistic lens.
- Create a permanent and visual presence of appreciation for Albert Bond Lambert in the Airport that bears his name.
- Compliment and coordinate with the site, architecture, and other public art installations in Terminal 1.

The site for the artwork will be the Terminal 1 Ticketing Lounge, a bright, open space which highlights the innovative design of Minoru Yamasaki. The project will sit at the base of one of the iconic windows in Terminal 1. It will be sited approximately 4-5' feet in front of the window to allow for movement around the glass. The glass wall will be constructed in the same quality of architectural art-glass as the glass walls in Concourse A and C, in order to develop a consistent visual vocabulary. Specifications will be provided to the selected artist. The glass dimensions will be 14' x 5.5', divided into four, 3.5' x 5.5' panels. As with the glass walls in Concourses A and C, the framework armature will lift the glass 1' above the ground. There are approximately 3" between each glass pane.

SELECTION PROCESS

Eligibility

This Invitation to Submit Qualifications is open to professional artists residing anywhere in the United States. Artists need not have prior experience working in glass, but should demonstrate an interest in exploring the medium.

Review Process

Artists will be selected based upon the qualifications, as determined through their submission materials and references. Artist submissions will be reviewed by the Airport Art Advisory Committee. The AAAC will recommend an artist to the Airport Director. The AAAC is not required to make recommendations from the submissions if, in its opinion, qualifications are not appropriate.

Selection Criteria

Artist qualifications will be reviewed by the AAAC based on the following criteria:

- Artistic excellence and innovation as demonstrated by past work and the submitted materials.
- Understanding of the project and ability to create an artwork that responds to the goals of the project.
- Past experience and/or stated interest in exploring glass as a medium.
- Availability to meet the project timeline.

ARTIST SCOPE OF WORK

Selected artist will work collaboratively with the glass fabricator (selected by the Airport) to develop and execute a work in glass. An anticipated work plan follows:

- 1) Attend an information session (in person or via teleconference) with a representative from the glass fabrication studio and a representative from Via Partnership to learn about different glass fabrication methods, learn about the glass studio and fabrication team, review drawings of the armature that will hold the glass, and review the project's schedule.
- 2) Research the history of Albert Bond Lambert, St. Louis Lambert International Airport, and other topics relevant to the development of the artistic concept.
- 3) Develop a two-dimensional design and a narrative description/artist statement for review by the Airport Art Advisory Committee and approval by the Airport Director. Consult, as needed, with the fabricator to discuss selection of the appropriate fabrication methods, materials, etc.

- 4) Work collaboratively with the fabricator to realize the translation of the Airport-approved design into glass. Artists may elect to travel to the fabricator’s studio (potentially an overseas trip) to work with the in-house craftspeople to finalize materials, techniques and design.
- 5) Attend project dedication events, as requested.

The Airport will contract directly for the architectural art-glass fabrication, the fabricator for the armature, and the installation of the glass.

BUDGET

Selected artist will be paid a design fee of \$10,000, inclusive of travel costs to St. Louis or to the fabrication studio (optional).

The Airport will hold a separate contract with the fabricator to consult with the selected artists and to fabricate and ship the glass. The Airport will also contract for the fabrication of the armature and the installation of the glass.

TIMELINE

February 3, 2020	Qualifications due
Mid-February 2020	AAAC reviews qualifications and recommends artist
May 2020	Selected artist submits design concept for approval
June 2020	Public unveiling of design
September 2020	Fabrication complete
Fall 2020	Installation

TO SUBMIT

Submit qualifications by Monday February 3, 2020 that include the following:

- A letter of interest that indicates your interest in the project and how you might approach the commission (PDF, no more than 2 pages). As stated above, no previous glass experience is required for this project, however the committee will benefit from an understanding of how each artist thinks their work would translate into this medium.
- A CV/resume with current contact information (PDF, no more than 3 pages).
- Names and contact information for 3 -5 professional references (PDF).
- Up to 10 sample images of previous artwork relevant to this project (JPEG files no larger than 10MB each).
- A corresponding image list with artwork title, medium, dimensions, brief description, location, date of work, commissioning entity and budget/price (PDF).

PLEASE DO NOT SEND SPECIFIC PROPOSALS AT THIS TIME.

Send all qualifications by February 3, 2020 to:

Angie Villa at villa@viapartnership.com

Associate, Via Partnership

Subject: Legacy Glass Project

Please use a file sharing service such as a Dropbox or Hightail.

For submission issues, contact Angie Villa at 314-735-9268 or villa@viapartnership.com.

QUESTIONS

Please submit all project questions via email to Angie Villa of Via Partnership villa@viapartnership.com no later than January 13, 2020. Responses to all questions will be posted on www.artoftravelstl.com by January 17, 2020.

ATTACHMENTS

1. Specifications of scale and location
2. Sample rendering in situ

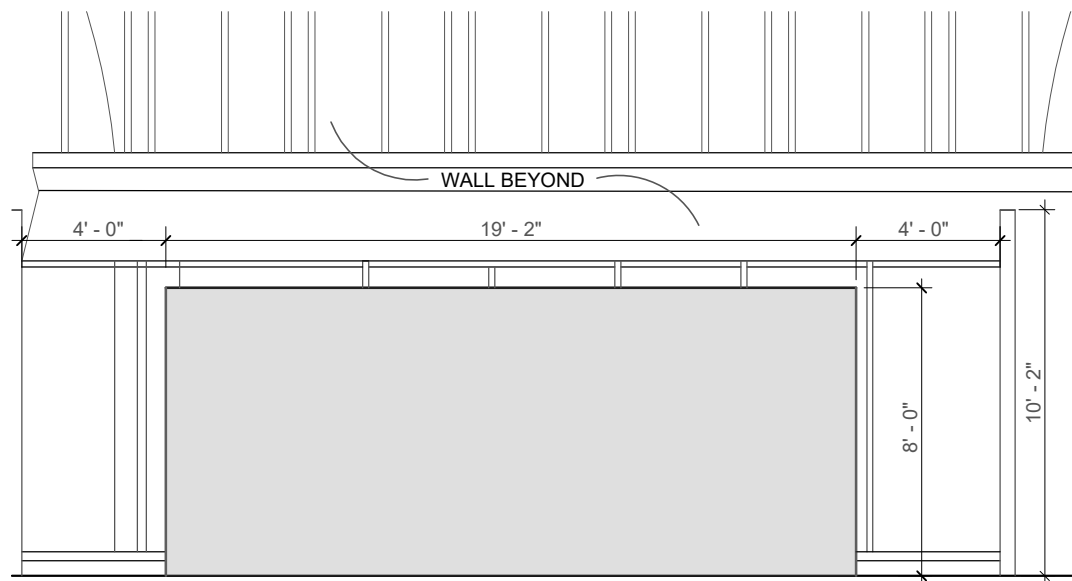

Front Elevation Ticketing Level T1 Art Display Area
Terminal 1 - Ticketing Level at Entry 5
3/16" = 1' - 0"

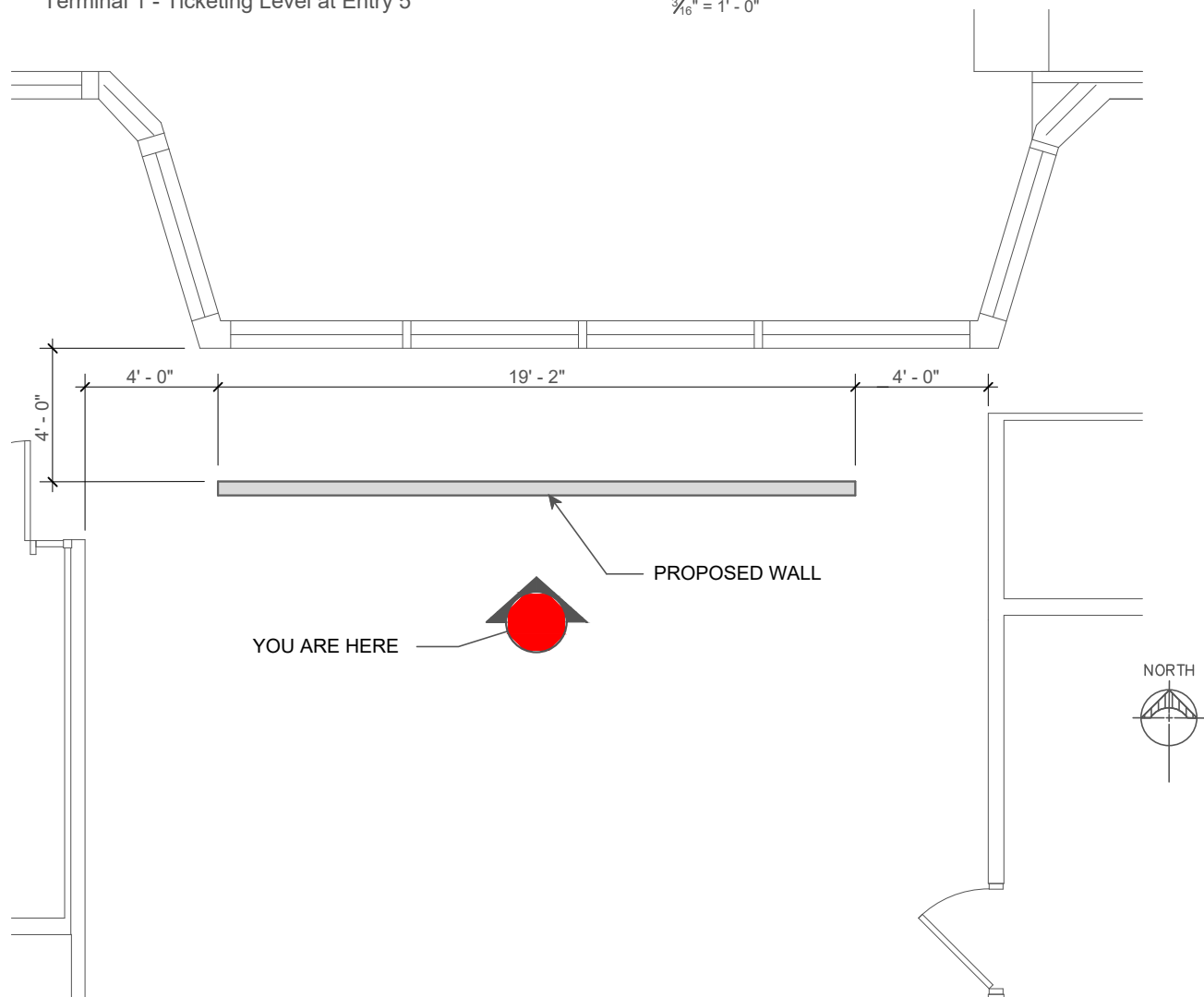

Existing Floor Plan Ticketing Level T1 Art Display Area
Terminal 1 - Ticketing Level at Entry 5
3/16" = 1' - 0"

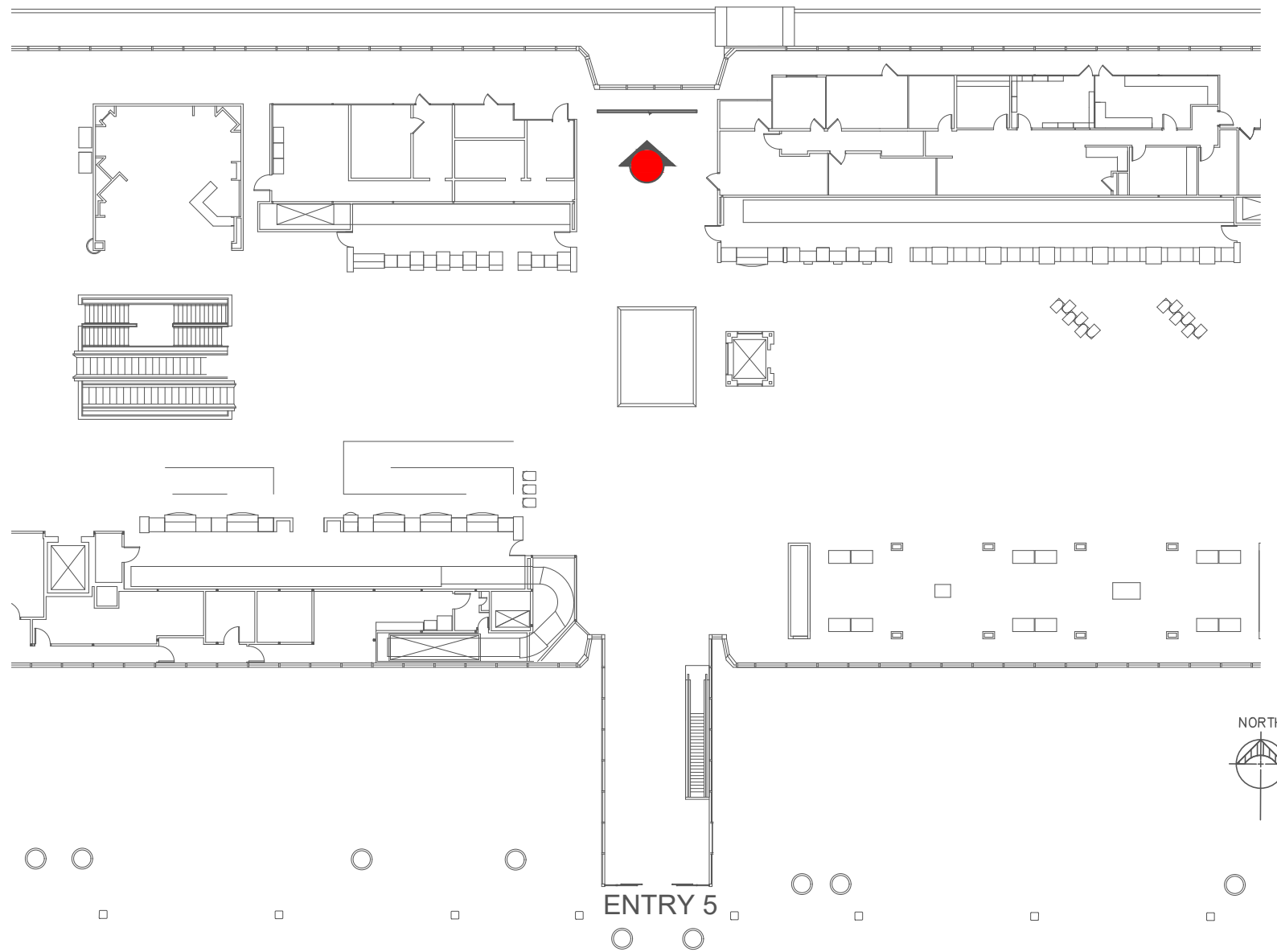

Overall Floor Plan Ticketing Level T1 Art Display Area
Terminal 1 - Ticketing Level at Entry 5
NOT TO SCALE



City of St. Louis, Public Relations /
P.O. Box 10212 St. Louis MO. / 63145 (314) 426-8125
OCTOBER 15, 2019

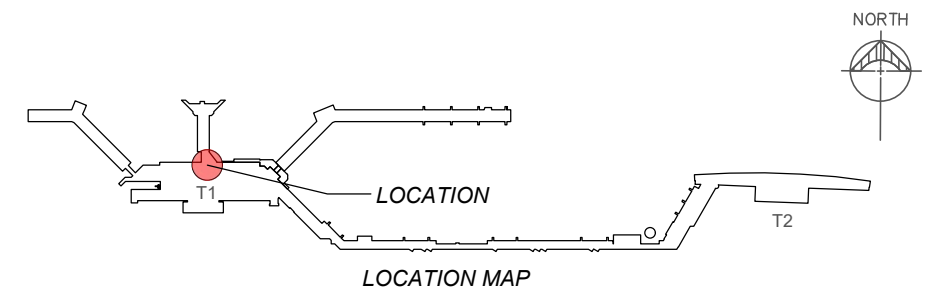

Legacy Glass Project

Conceptual rendering of glass panels at project site location in Terminal 1, Ticketing Level, below Terminal 1 skylight, facing north.

