

**CITY OF ST. LOUIS**  
**SERVICE AGREEMENT FOR**  
**INTERIOR LIVE PLANT MAINTENANCE SERVICES**  
**LAMBERT- ST. LOUIS INTERNATIONAL AIRPORT®**

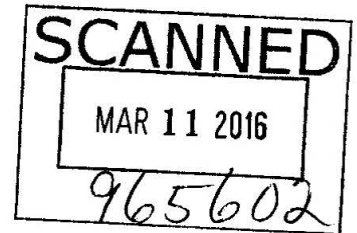

**CONTRACT NO.:**

**CONTRACT NOT-TO- EXCEED AMOUNT:   \$95,000.00**

**CONTRACTOR:**                   Rentokil North America, Inc. d/b/a Ambius  
3952 Clayton Avenue  
St. Louis, Missouri 63110

**FEDERAL I.D.**                   #23-1568350

**ESTIMATED ANNUAL ENCUMBRANCES:**

<b>FY 2015-2016</b>	<b>\$10,550.00</b>
<b>FY 2016-2017</b>	<b>\$31,670.00</b>
<b>FY 2017-2018</b>	<b>\$31,670.00</b>
<b>FY 2018-2019</b>	<b>\$21,110.00</b>

<b>CONTRACT AUTHORIZED BY:</b>	<b>ORDINANCE NO.</b>	<b>69985</b>
	<b>BUDGET ACCOUNT:</b>	<b>5638</b>

**LAMBERT-ST. LOUIS INTERNATIONAL AIRPORT**  
**ST. LOUIS, MISSOURI**

**CITY OF ST. LOUIS**  
**SERVICE AGREEMENT FOR**  
**INTERIOR LIVE PLANT MAINTENANCE SERVICES**  
**LAMBERT- ST. LOUIS INTERNATIONAL AIRPORT**

This Agreement, made and entered into this \_\_\_\_ day of \_\_\_\_\_, 2016 ("**Agreement**"), by and between the City of St. Louis, a municipal corporation of the State of Missouri (the "**City**") and Rentokil North America, Inc. d/b/a Ambius, a corporation organized and existing under the laws of the State of Pennsylvania ("**Contractor**").

**WITNESSETH THAT:**

**WHEREAS**, City owns and operates Lambert-St. Louis International Airport (the "**Airport**"); and

**WHEREAS**, City seeks to contract with the Contractor for Interior Live Plant Maintenance Services as more fully described herein.

**NOW, THEREFORE**, in consideration of the payments, terms, conditions, agreements, hereinafter set forth, to be made and performed by City, the Contractor hereby promises and agrees that it will faithfully perform all the services called for by this Agreement, in the manner and under the terms, covenant, and conditions hereinafter set forth.

## TABLE OF CONTENTS

<u>SECTION</u>	<u>PAGE</u>
<b>APPENDIX A-TECHNICAL SPECIFICATIONS</b>	
1.0 DEFINITIONS .....	5
2.0 SCOPE OF WORK .....	6
3.0 PERFORMANCE SPECIFICATIONS .....	7
4.0 EXTRA WORK .....	9
5.0 TERM .....	10
6.0 ADMINISTRATIVE PROCEDURES .....	10
7.0 RULES AND REGULATIONS .....	12
8.0 REPAIR OF DAMAGE .....	13
9.0 PAYMENTS .....	13
10.0 NOTICE OF A LOSS OR CLAIMS .....	14
11.0 REPLACEMENT OF PERSONNEL .....	14
12.0 PROHIBITED ACTS .....	14
13.0 RIGHT OF REVIEW .....	15
14.0 GOVERNING LAW AND FORUM SELECTION .....	15
15.0 WAIVERS OF LIEN .....	16
16.0 FACILITIES PROVIDED BY THE AIRPORT .....	16
17.0 PRECAUTIONARY MEASURES .....	16
18.0 STORAGE AND STAGING AREA .....	16
19.0 BADGING .....	17
20.0 UNIFORMS .....	18
21.0 PERFORMANCE & PAYMENT BOND .....	18

22.0 MISSOURI UNAUTHORIZED ALIENS LAW .....	18
23.0 GENERAL PROVISIONS .....	19
24.0 PREVAILING WAGE AND FRINGE BENEFITS .....	20
25.0 MEDIA INQUIRIES/ADVERTISING .....	21
26.0 CUSTOMER SERVICE .....	22
27.0 INSPECTIONS .....	23
28.0 MAPS .....	24

## **APPENDIX B-GENERAL SPECIFICATIONS**

1.0 INSURANCE AND INDEMNIFICATION .....	24
2.0 CANCELLATION .....	26
3.0 ASSIGNMENT AND SUBCONTRACTING .....	26
4.0 AFFIRMATIVE ACTION PROGRAM AND NON-DISCRIMINATION .....	27
5.0 MBE/WBE PARTICIPATION .....	28
6.0 RIGHT TO AUDIT CLAUSE .....	33
7.0 NOTICE PROVISION .....	34
APPENDIX "C" .....	36
Rates For Interior Live Plant Maintenance Services	

## **EXHIBITS AND ATTACHMENTS**

EXHIBIT "A" .....	38
Affidavit (Missouri Unauthorized Aliens Law)	
EXHIBIT "B" .....	40
Plant Maintenance Agreement Inventory	
EXHIBIT "C" .....	44
Color Rotation Program	
ATTACHMENT 1 .....	47
Maps	



**CITY OF ST. LOUIS  
LAMBERT - ST. LOUIS INTERNATIONAL AIRPORT**

**APPENDIX "A"**

**TECHNICAL SPECIFICATIONS  
(INTERIOR LIVE PLANT MAINTENANCE SERVICES)**

**1. DEFINITIONS**

The following terms and definitions are used in this agreement:

- A. **"Agreement"** means the contract between the City of St. Louis and Rentokil North America, Inc. d/b/a Ambius.
- B. **"Airport"** means the property owned by the City of St. Louis at Lambert-St. Louis International Airport.
- C. **"Airport Representative"** means the Airport Facilities Maintenance Manager or his/her authorized or designated representative.
- D. **"City"** means the City of St. Louis, owner and operator of Lambert-St. Louis International Airport.
- E. **"Commencement Date"** means the date the term of this Agreement begins which is March 1, 2016 as provided for in Appendix A, Section 5.
- F. **"Contractor"** means Rentokil North America, Inc. d/b/a Ambius.
- G. **"Contract Year"** means a consecutive twelve (12) calendar month period beginning on the Commencement Date and each twelve (12) consecutive calendar month period thereafter during the term of this Agreement.
- H. **"days"** means consecutive calendar days unless otherwise expressly stated.
- I. **"Director"** means the Director of Airports of the City of St. Louis and to his/her authorized representatives or designated representative.
- J. **"Expiration Date"** means the date the term of this Agreement ends which is February 28, 2019 as provided for in Appendix A, Section 5.
- K. **"Extras"** means additional service work or modifications, additions, or extras.
- L. **"Holiday"** means New Years Day, Memorial Day, Independence Day, Labor Day, Veterans Day, Thanksgiving Day, and Christmas Day.

- M. **"Provision"** means any term, covenant, warranty, condition, or provision under this Agreement.

## 2. **SCOPE OF WORK**

- A. The Contractor warrants, covenants, stipulates, and agrees that the Contractor, subject to and in accordance with the Provisions of this Agreement, shall furnish all labor, personnel, supervision, materials, plant material, supplies, and equipment required to maintain live plants and floral displays within the Airport's secure and non-secure public areas (see Appendix "A", Section 28 entitled "Maps") in accordance with the Performance Specifications (see Appendix "A", Section 3 entitled "Performance Specifications"), and as directed and requested in writing by the Airport Representative.
- B. The Contractor warrants, covenants, stipulates, and agrees that the Contractor, prior to performing any work under this Agreement, shall supply the Airport Representative with telephone numbers of supervisory personnel who will be available during normal business hours (Monday through Friday, 8:30 am, through 5:00 p.m., including Holidays). When called, said personnel shall be able to respond as needed to correct any deficiencies discovered by the Airport Representative that are attributed to the Contractor's work. See Appendix A, Section 3A.
- C. The Contractor warrants, covenants, stipulates, and agrees that the Contractor shall provide qualified and appropriately certified personnel to properly maintain the live plants and floral displays in the designated Airport areas according to the Performance Specifications, and in a manner acceptable to the Airport Director (see Appendix "A", Section 3 entitled "Performance Specifications").
- D. The Contractor warrants, covenants, stipulates, and agrees that the Contractor, unless expressly authorized in writing by the Airport Representative, shall not perform at any time any work that causes or results in the denial of access or the disruption of pedestrian traffic flows. Any work that requires closing an area to public or employee access for any length of time shall be performed between the hours of 12:00 a.m. (midnight) and 5:00 a.m., and shall be scheduled with the Airport Representative at least twenty-four (24) hours in advance. Under no circumstances will work be allowed to cause delay or cancellation of airline flights or interfere with safe and efficient Airport operations, as determined by the Airport Representative.
- E. All existing plants and planters shall remain the property of the Airport. All replacement plants and planters, including seasonal items, installed by the Contractor, shall become the property of the Airport upon payment by the City. Contractor at its cost, shall promptly and timely remove and properly dispose of

color rotation displays as requested and directed in writing by the Airport Representative.

F. Designated Areas of Service

Contractor shall maintain a written inventory of existing plants and planters by plant and document (in a form acceptable to the Airport Representative) plant species, sizes, and locations in the following “**Designated Areas of Service**” during the life of this Agreement (See Exhibit B entitled “Plant Inventory”):

1. Terminal 1/Ticketing Level (Including the Living Plant Wall located next to T1 Exit 5)
2. Terminal 1/Baggage Claim Level
3. Airport Authority Administrative Offices
  - a) Director’s Office Complex
  - b) Airport Properties Office
  - c) Airport Authority BDD Office Hall
4. A Concourse Ladies Restrooms
5. C Concourse Ladies Restrooms
6. E Concourse
7. Terminal 2 Ticketing Level
8. Terminal 2 Baggage Claim Level

- G. The map (see **Attachment 1**) shows the general layout of the areas in which the Contractor can expect to provide the plant maintenance services as ordered and requested by the City. The specific areas may be changed by the Airport Representative periodically throughout the term of this Agreement (See Appendix “A”, Section 31, Maps).

3. **PERFORMANCE SPECIFICATIONS**

- A. Contractor warrants, represents, stipulates, and agrees that the Contractor shall provide or comply with the following “**Performance Specifications**”:
1. Deliver and install all new/replacement plant materials;
  2. Select plants appropriate for indoor use for the various low to medium lighting conditions of the terminal buildings;

3. Select plants that have a longevity and durability that is suitable for heavily traveled public areas like the Airport;
4. 75% of new plants selected shall be 24 inches or taller, in order to have a presence in a large indoor area;
5. Planters shall be kept clean and free of trash;
6. Secure plants in planters in such a way as to minimize theft and prevent the hiding of contraband in planters, which could pose a security risk;
7. Clean up (remove) all dead and yellow foliage from plants and top of soil. Any leaf with more than 10% of its original surface area dead or discolored must be promptly removed;
8. Maintain on a weekly basis the plants and floral displays in the Airport, including all new/replacement plants and materials. Maintenance shall include, but not be limited to, watering, dusting, pruning, cleaning up planters, and removal of dead or yellow foliage from plants, as well as fertilization;
9. Replacement of plants shall be promptly made if after acclimation, more than 25% of the foliage is pruned, or more than 10% of the plant is discolored, or the plant's form or shape is no longer consistent with the standards associated with the plant species;
10. Rotation of plants shall be of sufficient frequency to maintain balanced foliage;
11. Physical removal and cleaning shall be the only acceptable method of disease and insect control. **Contractor warrants, represents, and agrees that no spraying of any insecticides shall occur at the Airport;**
12. Mulch and tip dressing shall be sufficient to cover all mechanics;
13. Replacement of plants installed by the Contractor **shall be at no additional charge to the City;**
14. Provide a Color Rotation Program. The color rotation display shall be of the size and type listed in **Exhibit C** entitled "Color Rotation Program" of this Agreement which is attached hereto and incorporated herein.
15. No plants shall be located in areas where they will be subject to damage from heat or cold;

16. Plants shall be located appropriate to traffic patterns and aesthetic appeal;
17. Prior to the performance of any work or services under this Agreement, Contractor shall submit a schedule to the Airport Representative for his/her review and written approval to show when regular service will be performed. The Airport Representative must be notified at least five (5) working days in advance of any requested schedule change and must approve in writing any deviation from the prescribed and authorized schedule;
18. Should the Airport Representative require “on-call” service for any provision of this Agreement, the services shall be performed within eight (8) hours from notification by the Airport Representative; and
19. All plant material shall be maintained in an insect and disease free condition (See Section 6.A.11).
20. Provide four (4) scent machines; two at each terminal in locations chosen by the Airport Representative. Provide scenting and maintenance on machines. Scents shall be chosen by the Airport Representative and may be changed for different seasons or Holidays.

#### 4. **EXTRA WORK**

- A. At the written request and direction of the Director, additional Interior Live Plant Maintenance Services work or modifications, additions, or Extras to the Interior Live Plant Maintenance Services may be required. The fee or charge for Extras will be agreed upon up front in writing on a case by case basis as described herein and in Appendix A, Section 9.A of this Agreement. For all work conducted under this Agreement, the total amount to be paid to the Contractor must not exceed the total Contract Not-To-Exceed Amount of this Agreement. (See Appendix A, Section 9.D).
- B. Any work not herein specified which may be fairly implied as included in the Agreement, of which the Director will be the sole and absolute judge, will be done by the Contractor without extra charge. The Contractor will do all Extras that may be requested or ordered by the Director in writing. No claim for Extras will be allowed in favor of the Contractor unless such Extras have been ordered in advance by written request of the Director. The Contractor will furnish the Director with itemized bills for all items included under this heading, and such bills may be verified or audited by the City. All bills for Extras done in any month, will be submitted to the Director, in writing, before the 15<sup>th</sup> day of the following month, and the amounts therein must be in accordance with the daily time, material, and equipment statements duly approved by the Director. As proof of costs, the Contractor will submit copies of itemized invoices received from the Contractor's

approved subcontractor(s) which have been previously reviewed and approved by the Contractor. Extras will be paid for on the basis of a fixed amount or rate or charge or any combination thereof to be agreed upon and approved by the Contractor and the Director in writing prior to such Extras being performed. (See Appendix A, Section 9.A).

5. **TERM**

The term of this Agreement will be for three (3) years beginning on the Commencement Date specified below and ending thirty-six (36) months thereafter unless terminated or cancelled as provided for in Appendix B, Section 2. This Agreement is expressly subject to, and will not become effective or binding on the City until, fully executed by all signatories of the City. The Commencement and Expiration dates will be as follows:

**Commencement Date: March 1, 2016    Expiration Date: February 28, 2019**

6. **ADMINISTRATIVE PROCEDURES**

- A. Before work under this Agreement commences, the Contractor will designate, by written notice to the Airport Representative, an experienced, competent and knowledgeable, full-time employee of the Contractor as the Contractor's "**Project Coordinator**". The Project Coordinator will be fully authorized to act for the Contractor in all matters covered by this Agreement. The Contractor will also furnish all supervisory personnel with copies of these specifications and will make certain that all such personnel understand the provisions thereof.
- B. When necessary, or as requested by the Airport Representative, the Contractor will make periodic reports and recommendations to the Airport Representative with respect to conditions, transactions, situations or circumstances encountered by the Contractor relating to the services to be performed under this Agreement.
- C. The Contractor's performance hereunder must be in accordance with the highest standards of care, skill, and diligence provided by professionals who perform services similar to the services contemplated by this Agreement. All work will be executed in the most workmanlike, safe and substantial manner and everything will be furnished by Contractor that is necessary to complete and perfect the aforesaid work according to the design and intention, whether particularly specified or not which may be inferred from this Agreement and its specifications. Work which should properly be performed by skilled laborers, will not be attempted by common laborers.
- D. The Contractor will ensure that all equipment and temporary offices and trailers used on the job are conspicuously marked with both the name and

telephone number of the Contractor. (if applicable)

- E. Daily site clean-up must be accomplished by the Contractor. This clean-up must include the placing of material, tools, and equipment in a neat, safe, and orderly arrangement. Equipment must never be allowed to block access to existing facilities. Rubbish, debris, rubble, and garbage must be properly removed daily and disposed of by the Contractor in accordance with all applicable local, state, and federal laws and regulations. The Contractor will acknowledge, stipulate, and agree that the City and its officers, agents, representatives, or employees are not responsible or liable for, in any way whatsoever, for any hazardous condition created by, arising out of, or incidental to the Interior Live Plant Maintenance Services performed by the Contractor or its officers, employees, contractors, representatives, or agents under this Agreement. (See Appendix B, Section 1 entitled "Insurance and Indemnification.")
- F. The Contractor will furnish, and have on the job at all times, ample equipment to properly and safely carry out the work contemplated herein including such tool or equipment as may be necessary to meet emergency requirements.
- G. The Contractor will give personal attention to the performance of this Agreement and will furnish to the Airport Representative a listing of all employees (including subcontractor's employees) performing services under this Agreement. (See also Appendix B, Section 3 entitled "Assignment and Subcontracting") This listing of said employees will be updated and maintained by the Contractor throughout the term of this Agreement. The Contractor will be present, either in person, or have a duly authorized representative (i.e., Project Coordinator or supervisory personnel) at the site of the work continuously during working hours, throughout the progress of the work, to receive directions or furnish information. Any instructions or directions given to the Project Coordinator or supervisory personnel of the Contractor will be considered the same as given to the Contractor in person.
- H. Contractor, at its cost, will be required to secure all applicable permits and licenses and approvals required or necessary to fulfill the Provisions of the Agreement.
- I. The Contractor will attend a pre-performance conference prior to commencement of any work under this Agreement. Said conference will be after the date of Agreement execution, and prior to start of the work.
- J. The work to be performed under this Agreement is on an active Airport. Therefore, prior to the start of any work under this Agreement, the Contractor will provide the Airport Representative with a work schedule which will indicate a proposed sequence and time schedule of the work to be accomplished for the Airport Representative's prior written approval. (See Appendix A, Section 2, entitled "Scope of Work".)



- K. In case of an emergency, the Director, Operations Supervisor, or either of their representatives, will have authority to order the Contractor to immediately terminate work and clear the area of personnel and equipment. The Contractor will immediately comply to such an order with all possible speed.
- L. The Airport Representative will determine the amount, classifications, acceptability, and fitness of all work to be done, and will decide all questions which may arise relative to the proper performance of this Agreement, and his decisions will be final and conclusive, except as provided for in Appendix A, Section 13.
- M. The City reserves the right to solicit bids and award contracts to other contractors for any modifications or additions to the Interior Live Plant Maintenance Services. The City reserves the right to furnish components, parts, supplies, and materials at its discretion or to perform the work contemplated herein. (See Appendix A, Sections 9.B. and 23.G).

## **7. RULES AND REGULATIONS**

- A. Contractor warrants, covenants, represents, stipulates, and agrees that the Contractor will comply with all applicable rules and regulations including, resolutions, plans, operating directives, Airport certification manual, and directives promulgated or established by the Airport Authority, the Airport Commission, the Director, or the City, as they may be amended from time to time, in performing the work or services contemplated herein or the Provisions of this Agreement. Contractor warrants, covenants, represents, stipulates, and agrees that the Contractor will comply with all statutes, laws, ordinances, orders, judgments, decrees, permits, regulations, environmental plans and programs, environmental permits, directions, and requirements of the City as may be amended from time to time, and all federal, state, city, local and other governmental authorities, now or hereafter applicable, in performing the Provisions of this Agreement and the work or services contemplated herein.
- B. The Contractor will be responsible for compliance with all Airport Security Regulations, Airport Security procedures, and TSA 1500 as they may be amended from time to time. Any and all violations by the Contractor or its officers, employees, subcontractors, independent contractors, agents, or representatives pertaining to Airport Security resulting in a fine or penalty to the City or the Contractor, or its officers, employees, agents, or representatives, will be the responsibility of the Contractor. City will be reimbursed (within ten (10) days of the City's request) for any such fines or penalties imposed on the City.
- C. The Contractor will be responsible for the work of all subcontractors and agents, and all work must be kept under the Contractor's control. A complete list of all such subcontractors will be submitted to the Director for his/her prior written



approval (See Appendix B, Section 3 herein).

- D. The Contractor will not be entitled to any claim for damages or losses whatsoever against the City or its officers, employees, agents, representatives, due to hindrance or delay from any cause whatever in the progress of the work or any portion thereof including without limitation, loss of profits, and actual, consequential, special, or incidental damages.

## **8. REPAIR OF DAMAGE**

The Contractor will promptly report any property of the City or third parties damaged by Contractor's operations or employees. The Contractor will make no repairs or replacements to City property without the prior written approval of the Airport Director.

## **9. PAYMENTS**

- A. The Contractor shall submit to the Airport Representative for payment by the City, a monthly-itemized invoice for work performed under this Agreement at the rates and amounts outlined in the attached Appendix C, subject to and in accordance with the Provisions of this Agreement. The invoice shall identify the contract and ordinance numbers and shall contain line items of daily labor man-hours, materials, equipment, and markup. Labor man-hours, materials and equipment used each day will be reflected on a separate daily work completed report, included with each monthly-itemized invoice. The report will detail the work completed each day and identify the date and time the work was performed. Copies of Distributor's invoices must be attached for all materials and rental equipment. For Extras authorized in writing by the Director, the Contractor shall invoice the City at the rates, charges, and amounts as authorized in writing by the Director as set out in Appendix A, Section 4. All payments shall be contingent upon the appropriations of sufficient funds by the City annually.
- B. Nothing in this Agreement will be construed or interpreted to create a debt, liability, or obligation of any kind whatsoever on the City for the City to order or request any particular amount of work or services. (See also Appendix A, Sections 6.M. and 23.G.)
- C. The Contractor warrants, covenants, represents, stipulates, and agrees to submit invoices for the services and work performed pursuant to this Agreement in a timely manner and as provided for in this Agreement. The Contractor acknowledges and agrees that the City will not be required or obligated to pay any invoice submitted to the City by the Contractor more than six (6) months after the expiration or earlier termination of this Agreement or be responsible for any costs or expenses incurred by the Contractor for services or work performed pursuant to the Agreement for which invoices have not been submitted to the City for payment

within six (6) months of the expiration or earlier termination of this Agreement.

- D. The total Contract Not-To Exceed Amount of this Agreement is Ninety-Five Thousand Dollars (\$95,000.00).

**10. NOTICE OF LOSS OR CLAIMS**

- A. The Contractor will indemnify, defend, and save harmless the City, its officers, employees, and agents from all suits or actions, or losses brought against or suffered by the City, its officers, employees or agents, for or on account of any injuries or damages received or sustained by any party or parties by or from the Contractor, his employees, representative, or agents, in the performance of the work herein specified, or in consequence of any negligence in guarding the same, or any defective materials or equipment used, or by or on account of any act or omission of the said Contractor.
- B. The Contractor will indemnify, defend, and save harmless the City, its officers, employees, representatives, and agents from the payment of any and all claims, demands, damages, or costs arising out of any infringement, or alleged infringement of intellectual property rights including, without limitation, the use of any patent or patented device, article, system, arrangement, material or process used by the Contractor or its officers, employees, representative, or agent in the execution of this Agreement.
- C. The Contractor shall within seven (7) days of service or demand, provide written notification to the Director of all suits or action or losses arising out of the Agreement.

**11. REPLACEMENT OF PERSONNEL**

Contractor agrees to promptly replace the manager or any employee working under this Agreement should the Airport Director feel and recommend that such should be done for the good of the services being rendered. The Airport Director's decision will be final and binding.

**12. PROHIBITED ACTS**

Contractor will not do or permit to be done any act which:

- A. Will invalidate or be in conflict with any insurance policies covering the Airport or the City, or any part thereof, or upon the contents of any building thereon;

- B. Will increase rates of any insurance, extended coverage or rental insurance on the Airport or the City, or any part thereof, or upon the contents of any building thereon;
- C. In the opinion of the Airport Representative, will constitute a hazardous condition, so as to increase risks normally attendant upon the operations enumerated in this Agreement;
- D. Will constitute a nuisance in or on the Airport or which may result in creation, commission, or maintenance of a nuisance in or on the Airport; or
- E. May interfere with the effectiveness or accessibility of the drainage of any sewage system, fire protection system, sprinkler system, alarm system, fire hydrants and hoses if any, installed or located in or on the Airport.
- F. If by reason of the Contractor's failure to comply with the provisions of this section, any fire insurance, extended coverage or rental insurance rate on the Airport, or any part thereof, or upon the contents of any building thereon will be at any time higher than it otherwise would be, then the Contractor will on demand, pay the City the increase in the cost of insurance premiums paid or payable by the Airport which was charged because of such violation by the Contractor. For the purpose of this section, "Airport" includes all structures or improvements located thereon.

**13. RIGHT OF REVIEW**

Contractor has the right to take any decision or direction of the Airport Representative to the Director for his/her review and decision. The decision of the Director will be final and binding. All requests for review must be in writing and within 24 hours of the Airport Representative's decision in dispute, and must set forth clearly the cause for such request of review. No review will be allowed by the Director which has not first been considered by the Airport Representative. (See Appendix A, Section 6.L).

**14. GOVERNING LAW AND FORUM SELECTION**

This Agreement is made and entered into in the State of Missouri, and Missouri law, the City's charter and ordinances, as they may be amended from time to time, will govern and apply to this Agreement. Any cause of action, claim, suit, demand, or other case or controversy arising from or related to this Agreement must be brought only in a federal or state court in The City of St. Louis, Missouri. Contractor and the City hereby admit and consent to the jurisdiction and venue of such courts. The Provisions of this section survive the expiration or early termination of this Agreement.

**15. WAIVERS OF LIEN**

Upon completion of work contemplated herein, and if requested by the City, the Contractor will submit within five (5) business days of the City's request full waivers of lien from every entity involved in the performance of this Agreement. Lien waivers must be submitted on forms and executed in a manner acceptable to the Airport Representative. Contractor will warrant, covenant, represent, stipulate, and agree not to permit any mechanics' or materialmen's liens or any other lien or encumbrance to be attached or foreclosed upon the City's property or any part or parcel thereof, or on the improvements thereon, by reason of any work or labor performed or materials furnished by any mechanic, materialman, contractor, or any other reason.

**16. FACILITIES PROVIDED BY THE AIRPORT**

City, subject to and in accordance with the Provisions of this Agreement, will provide the right of ingress and egress to all areas herein specified in order for the Contractor to perform the work and services contemplated herein.

**17. PRECAUTIONARY MEASURES**

Contractor warrants, covenants, represents, stipulates, and agrees the Contractor shall exercise every precaution to prevent injury to persons or damage to property and avoid inconvenience to the City's travelers, licensees, and invitees, or airlines operating at the Airport, or other users of the Airport. Contractor shall without limiting the generality hereof, place such watchmen, erect such barricades and railings, give such warnings, display such lights, signals, or signs and exercise such precautions against fire, or electrocution, and take such other precautions as may be necessary, proper or desirable.

**18. STORAGE AND STAGING AREA**

- A. Location of storage and transfer area ("**Transfer Area**") will be assigned by the Airport Representative in writing (if applicable). If assigned, the Transfer Area will be used for storage of the Contractor's equipment and property, and will be maintained by the Contractor at its cost and to the City's standards as provided for in this Agreement. Assignment of the Transfer Area will be based on availability of space.
- B. The Contractor is responsible for the security of its equipment and must maintain and improve the Transfer Area as directed by the Airport Representative. The Contractor acknowledges, stipulates, and agrees that the City (including its officers, employees, agents or representatives) will not be responsible or liable for any vandalism, theft, casualty, loss, or damages of any kind whatsoever to the Contractor's equipment, containers, compactors, parts, tools, or supplies, or other

personal property.

- C. City, subject to and in accordance with the Provisions of this Agreement, will provide the right of ingress and egress to all areas required in the performance of the Contractor's services.

## **19. BADGING**

- A. The Contractor shall comply with all applicable federal, state and local governmental laws and regulations as well as rules and regulations of the Airport as may be amended from time to time. (See Appendix A, Section 7.A)
- B. The Contractor at its cost shall supply to and update as needed for the Airport Police Security Operations Bureau, a list of the Contractor's employees to be issued an Airport Employee Badge.
- C. The Contractor at its cost, if requested by the City, shall provide verification of a five (5) to ten (10) year employee background check of each employee to be issued an Airport Employee Badge.
- D. The Contractor shall, when requested and ordered by the Airport Representative, schedule with the Airport Police Security Operations Bureau to have each employee, to be issued an Airport ID Badge, fingerprinted, for a criminal history check. This process will be used to issue Airport Identification Badges to all Contractor employees assigned to work within the Security Identification Display Area ("SIDA"). The Contractor shall maintain at all times adequate control of said identification badges. All employees issued identification badges will be required to attend the SIDA class offered by the Airport Police. The Contractor shall bear the cost of providing badges for the Contractor's employees working under this Agreement. The cost for badging is approximately \$80.00 per employee and includes the cost of the badge, background check, fingerprinting and the SIDA course. Replacement cost for lost, stolen, or damaged identification badges will be the sole responsibility of the Contractor.
- E. The Contractor is responsible for compliance with all Airport Security Regulations, Airport Security procedures, and TSA 1542 as they may be amended from time to time. Any and all violations by the Contractor or its officers, employees, subcontractors, agents, or representatives pertaining to Airport Security resulting in a fine or penalty to the City or the Contractor, or its officers, employees, agents, or representatives, will be the responsibility of the Contractor. The City will be reimbursed (within ten (10) days of the City's request) for any such fines or penalties imposed on the City (See Appendix A, Section 7.B).

- F. Due to the amount of time needed to complete the badging process, it is recommended that the Contractor begin the process at least thirty (30) days prior to February 1<sup>st</sup> of each year that this Agreement is in effect.

**20. UNIFORMS**

Contractor, at its costs, shall provide uniforms for all its employees assigned to the Airport. Such uniforms are to bear the company's name and be approved by the Airport Representative in writing.

**21. PERFORMANCE & PAYMENT BOND**

- A. At or prior to the execution of this Agreement, the Contractor shall immediately execute a performance bond and a payment bond each in the amount of Five Thousand Dollars (\$5,000.00) with surety satisfactory to the City conditioned on the full and faithful performance of all Provisions of this Agreement to be executed. Affirmation by the Surety Company to execute the performance bonds and the payment bonds must be executed by Attorney-In-Fact for the surety company before a licensed Notary Public. The payment bonds must comply with the coverage requirements and conditions of Section 107.170 RSMo. The City will allow submittal of one year renewable bonds to meet the requirements of this Section 21. The Contractor shall notify the City no later than thirty (30) days prior to the termination, cancellation, or non-extension of the performance bonds and/or payment bonds and if the Contractor's performance bonds and/or payment bonds are terminated, cancelled, not renewed or extended, the Contractor shall promptly provide the City with a replacement bond(s) in full compliance with this Section 21. Any sum or sums derived from said performance and/or payment bonds will be used for the completion of this Agreement and the payment of laborers and material suppliers, as the case may be.
- B. Copies of the performance bonds and the payment bonds, in a form acceptable to the City, must be given to the Airport Representative for approval before the work of this Agreement begins.

**22. MISSOURI UNAUTHORIZED ALIENS LAW**

As a condition precedent for the award of this Agreement and prior to performing any work or services under this Agreement, the Contractor, shall, pursuant to the applicable provisions of Sections 285.525 through 285.555 of the Revised Statutes of Missouri 2000, as amended (the "**Missouri Unauthorized Aliens Law**"), by sworn affidavit and provision of documentation, affirm its enrollment and participation in a federal work authorization program with respect to the employees working in connection with this Agreement. The Contractor shall also affirm in said affidavit that it does not knowingly employ any person who is an unauthorized alien in connection with this Agreement pursuant to the Missouri



Unauthorized Aliens Law. A copy of an affidavit in a form acceptable to the City is attached hereto and incorporated herein as **Exhibit A** entitled "Affidavit". Contractor's failure to comply at all times with the Missouri Unauthorized Aliens Law or the provisions of this Agreement related to the Missouri Unauthorized Aliens Law may result in the termination of this Agreement by the City and/or the City seeking other remedies available to the City at law or in equity. In addition, the State of Missouri may impose penalties or remedies for violations of the Missouri Unauthorized Aliens Law as set forth therein. The Contractor shall promptly and timely deliver to the City a fully executed original of the Affidavit (see Exhibit "A") including any required documentation in accordance with the Missouri Unauthorized Aliens Law prior to performing any work under this Agreement.

## **23. GENERAL PROVISIONS**

- A. The Contractor is, and at all times hereunder, will be and remain an independent contractor and nothing herein will be interpreted or construed to mean that the Contractor or any of its employees or agents is an employee or agent of the City.
- B. The Contractor shall coordinate the services performed under this Agreement with the Airport Representative designated by the Airport Director.
- C. This Agreement will be the entire agreement and no amendment or modification will be made (except as expressly provided for herein) unless in writing and signed by the parties hereto.
- D. The City of St. Louis and the Contractor agree that this Agreement and all contracts entered into under the Provisions of this Agreement are binding upon the parties hereto and their successors and permitted assigns.
- E. A waiver by either party of the Provisions hereto to be performed, kept, or observed by the other party will not be construed as or operate as a waiver of any subsequent default or breach of any of the terms, covenants, or conditions of this Agreement. Any waiver by either party must be in writing and signed by the party waiving.
- F. The Contractor shall keep and maintain such records and reports as are necessary for the City to determine compliance with the obligations of this Agreement. Such records must be maintained by the Contractor for at least three (3) years after the expiration or termination of this Agreement. The City reserves the right to investigate, audit, and review, upon written request, such records and documents, in order to determine compliance with this Agreement. (See Appendix B, Section 6 entitled "Right To Audit Clause").
- G. Contractor acknowledges, understands, stipulates, and agrees that the City retains the right to receive bids and award contracts on any modifications, deletions, or additions to the Interior Live Plant Maintenance Services contemplated herein. In

addition, the City retains the right to furnish materials or supplies at its discretion, or perform for itself, any work contemplated herein. (See Appendix A, Sections 6.M and 9.B).

- H. No alderman, commissioner, director, board member, officer, employee or other agent of the City will be personally liable under or in connection with the Agreement.
- I. Neither party will be deemed in violation of this Agreement, if it is prevented from performing any of the obligations hereunder by reason of strikes, boycotts, labor disputes, embargoes, shortage of material, acts of God, acts of a public enemy, acts of a superior governmental authority, riots, rebellion, or sabotage, or any other circumstances for which it is not responsible and which is not within its control. (See Appendix A, Section 23K).
- J. In the event any Provision herein contained is held to be invalid by a court of competent jurisdiction, the invalidity of any such Provision will in no way affect any other Provision, herein contained, provided the invalidity of such Provision does not materially prejudice either party hereto in its respective rights and obligations contained in the valid Provisions of this Agreement.
- K. Time is of the essence in this Agreement. The parties agree that time will be of the essence in the performance of each and every obligation and understanding of this Agreement.
- L. Unless otherwise expressly provided for herein, when the consent, approval, waiver, release, or certification ("**Approval**") of either party is required under the terms of this Agreement, such Approval must be in writing and signed by the party making the Approval. Whenever the Approval of the City or the Director of Airports is required, the Approval must be from the City's Director of Airports or his/her authorized or designated representative.

#### **24. PREVAILING WAGE AND FRINGE BENEFITS**

The Contractor warrants, covenants, represents, stipulates, and agrees that all employees and subcontractor's employees performing any work under and subject to the terms of this Agreement at the Airport will be paid not less than the prevailing hourly rate of wages and fringe benefits as determined by the United States Secretary of Labor, or his/her authorized representative, in accordance with prevailing rates in the locality of the metropolitan St. Louis area pursuant to 41 U.S.C. 351 ex seq., as amended, except for any person engaged in an executive, administrative or professional capacity. This Section 24 is subject to and is in accordance with City Ordinance No. 62124.



25. **MEDIA INQUIRIES / ADVERTISING**

- A. If contacted by any media entity or other third party ("**Media Entity**") about this Agreement or the services or work performed by the Contractor under this Agreement ("**Airport Project**"), the Contractor will refer the Media Entity to the Airport's Public Relations Manager. This includes, without limitation, trade publications.
- B. Contractor acknowledges and agrees that any printed articles, press releases, web articles, social media communications or case studies about an Airport Project must be approved in writing by the Airport's Public Relations Manager prior to being made public by the Contractor. Contractor will have no right to use the trademarks, symbols, logos, trade names or the name of the City or the Airport, either directly or indirectly, in connection with any production, promotional service, publication or advertising without the prior written consent of the Airport's Public Relations Manager.
- C. Contractor will treat all knowledge of the City's intentions, operations or procedures, and business as confidential and at no time divulge such information without the prior written consent of the Director, unless otherwise required by a court order or subpoena. Contractor will timely inform the City of any such order or subpoena prior to releasing said confidential information.
- D. Advertisements discussing an Airport Project must be approved by the Airport's Public Relations Manager in writing prior to publication or must include a prominent disclaimer that neither the City nor the Airport necessarily endorses the Contractor's work.
- E. Any quotes or testimonials from City or Airport staff may not be used unless pre-approved in writing by the Airport's Public Relations Manager.
- F. Photos taken by Contractor of Airport Projects must be pre-approved in writing by the Airport's Public Relations Manager. Contractor acknowledges and understands that some photos may contain security-sensitive information and publication may violate federal laws or regulations or Airport security rules or procedures.
- G. The Airport's Public Relations office must be given at least three (3) business days' notice to review request and materials. The Airport's Public Relations office coordinates media, web, postings, printed materials, advertisements and other public communication about Airport Projects. Public Relations main number is: 314-426-8125.

**26. CUSTOMER SERVICE**

Contractor, on behalf of itself and all subcontractors, acknowledges that customer service to the traveling public is a primary concern for the City and that customer service is the shared responsibility of all employees at the Airport, no matter their role or function. Contractor agrees that all employees performing service at the Airport pursuant to this Agreement shall:

- A. Demonstrate excellent customer service at all times when in contact with users of the Airport.
- B. Act in a courteous and helpful manner at all times with travelers, fellow employees, and all other users of the Airport, including but not limited to, appropriate greetings and assistance to travelers.
- C. Ensure that travelers have a positive Airport experience and must at all times behave in a businesslike and professional manner while on Airport property.
- D. Speak English, except when necessary to accommodate customers; refrain from using foul or inappropriate language in public areas; smile and use a pleasant tone of voice when conversing with travelers and all other Airport users; be actively working while on duty and refrain from gathering and “chatting” in groups while on duty, unless necessary; refrain from the use of non-business cell phones while on duty; refrain from napping or sleeping in public areas.
- E. Not utilize public seating, boarding areas, gate areas or lounge areas within the terminals and concourses. The above areas are intended for use by the traveling public and not as rest or lounge facilities for employees.
- F. Additionally, Contractor agrees that it shall:
  - 1. Provide proper training of all employees including on-going customer service training and for the certification or licensing of employees in all areas of service as their duties might legally require.
  - 2. Participate in the Airport’s customer service program if required by the Director in writing.
  - 3. Respond in writing to every complaint issued regarding its employees interaction with the public, written or oral, within seven (7) calendar days of the complaint and shall make good faith efforts to explain, resolve or rectify the cause of the complaint. Contractor shall provide the Director with a copy of each such complaint and its written response thereto.

4. Generate a written Customer Service Plan (the “**Plan**”) for its employees that is provided to the Director for approval upon fifteen (15) days written notice. Should the Director not approve the Plan, Contractor shall revise and resubmit the Plan within fifteen (15) days of written notice of the denial.

**27. INSPECTIONS**

- A. The Airport Representative will at all times have free access to the work, as well as the equipment, and shops of the Contractor for the purpose of determining Contractor’s compliance with the Provisions of this Agreement. The Airport Representative may perform periodic inspections of the work as outlined in the Agreement, to determine that services performed by the Contractor meet with required standards and the Contractor will be required to timely and promptly make any improvements as required by the Airport Representative at no additional charge to the City (See Appendix A, Sections 2 & 6).

**28. MAPS**

**A general map of the areas to be maintained is attached as “Attachment 1” and incorporated herein.**

- A. The Airport Representative has the sole discretion to make alterations in the line, grade, form, or dimensions of the map at any time, either before or after commencement of this Agreement, and if such alterations diminish the square footage for which the Contractor is to provide Interior Live Plant Maintenance Services hereunder, Contractor acknowledges and agrees that such alterations will not constitute a claim for any loss or damages of any kind whatsoever against the City including, without limitation loss of profits, actual, consequential, special, or incidental damages.
- B. No change, variation or deviation from the map or specifications will be made by the Contractor except by prior written order of the Airport Representative. Should the Contractor find, at any time during the progress of the work, that in his opinion existing conditions demand, make desirable or beneficial a modification in requirements covering any particular item or items, Contractor is required to promptly transmit such information to the Airport Representative for his decision and instructions.
- C. The Contractor shall perform all work within area shown on the map as ordered and directed in writing by the Airport Representative and shall not obstruct adjacent runways, taxiways, ramps, roads, walks, parking areas, etc. with materials or equipment. The Contractor shall also see that its operations do not interfere with other City department operations. The Contractor shall coordinate operations closely with the Airport Representative.

**CITY OF ST. LOUIS  
LAMBERT - ST. LOUIS INTERNATIONAL AIRPORT**

**APPENDIX "B"**

**GENERAL SPECIFICATIONS  
(INTERIOR LIVE PLANT MAINTENANCE SERVICES)**

**1. INSURANCE AND INDEMNIFICATION**

- A. The Contractor, at its expense, at all times during the term hereof, will cause St. Louis County, the City and its Board of Aldermen, the Airport Commission, and their respective officers, agents and employees and the Contractor to be insured **on an occurrence basis** against all claims and demands by third persons for bodily injury (including wrongful death) and property damage arising or alleged to arise out of the activities or omissions of the Contractor, its officers, agents, employees, contractors, subcontractors, licensees, invitees, representatives, and independent contractors pursuant to this Agreement under the following types of coverage:
1. Comprehensive General Liability;
  2. Comprehensive Automobile Liability (any vehicles, including owned, hired and non-owned).
- B. **The minimum limits of coverage for the above classes of insurance must equal a single limit of Two Million Dollars (\$2,000,000.00) comprised of such primary and excess policies of insurance as the Contractor finds it feasible to purchase during the term of this Agreement** and will name St. Louis County, the City and its Board of Aldermen, the Airport Commission, and their respective officers, agents and employees (the "CITY" as used in this Section) by endorsement as an "Additional Insured". Prior to execution of this Agreement, Contractor will provide certificates of said insurance and all endorsements required pursuant to this Agreement to the Airport Representative in form and content satisfactory to the City. In addition, the Contractor will also mail or fax a copy of the Certificate of Insurance and all required endorsements to:

St. Louis Airport Police Department  
P.O. Box 10212, Lambert Station  
St. Louis, Missouri 63145  
Attn: Sharon Wilson, Bureau of Security Operations  
Phone: 314-426-8002  
Fax: 314-890-1325

- C. Such liability insurance coverage must also extend to damage, destruction and injury to CITY owned or leased property and CITY personnel, and caused by or resulting from work, acts, operations, or omissions of Contractor, its officers, agents, employees, contractors, subcontractors, licensees, invitees, representatives, and independent contractors and, contractual liability insurance sufficient to cover Contractor's indemnity obligations hereunder. The CITY will have no liability for any premiums charged for such coverage, and the inclusion of the CITY as an Additional Insured is not intended to, and does not make the CITY a partner or joint venturer with Contractor in its operations hereunder. Each such insurance policy must provide primary coverage to the CITY when any policy issued to the CITY provides duplicate or similar coverage and in such circumstances, the CITY's policy will be excess over Contractor's policy.
- D. The Contractor will protect, defend, and hold St. Louis County, the City and its Board of Aldermen, the Airport Commission, and their respective officers, agents and employees completely harmless from and against all liabilities, losses, suits, claims, judgments, and fines or demands arising by reason of injury or death of any person or damage to any property, including all reasonable costs for investigation and defense thereof (including but not limited to attorneys' fees, court costs, and expert fees), of any nature whatsoever arising out of or incident to this Agreement and the use or occupancy of the City's premises and the acts or omissions of Contractor's officers, agents, employees, contractors, subcontractors, licensees, invitees, or independent contractors regardless of where the injury, death, or damage may occur, unless and to the extent such injury, death or damage is caused by the negligence of the City. The Director or his/her designee will give to Contractor reasonable notice of any such claims or actions. The Contractor will also use counsel reasonably acceptable to the City Counselor of the City or his/her designee, after consultation with the Director or his/her designee, in carrying out its obligations hereunder. The Provisions of this section survive the expiration or early termination of this Agreement.
- E. The Contractor will maintain Worker's Compensation and Employer's Liability Insurance at least at the statutory requirement and in accordance with Missouri laws and regulations. Contractor will require that all of its subcontractors or licensees similarly provide such coverage. The City, its officers, employees, or agents will not be liable or responsible for any claims or actions occasioned by Contractor's failure to comply with the provisions of this subsection. The indemnification provisions of this Agreement apply to this subsection. It is expressly agreed that the employees of the Contractor are not employees of the City for any purpose, and that employees of the City are not employees of the Contractor.

## **2. CANCELLATION**

- A. The City retains the right to cancel this Agreement immediately upon written notice to the Contractor, if the Contractor should fail to properly keep any Provision of this Agreement; or, if the quality of service should fall below the specified standards as determined by the City; or, if the Contractor should fail or refuse to render the amount of service required.
- B. The Contractor has the right to cancel this Agreement upon ten (10) days written notice to the City, without penalty, if the City should fail to keep any of the Provisions of this Agreement.
- C. Either party has the right to cancel this Agreement without cause upon ten (10) days written notice to the other party with no liability to the canceling party and such a cancellation will be deemed a no fault cancellation.
- D. Notwithstanding anything to the contrary herein, it is expressly understood by the parties hereto that this Agreement will terminate immediately upon the failure of budgetary appropriations with no resulting liability to the City.
- E. If requested in writing by the Airport Representative or in the event of cancellation, termination, or the expiration of this Agreement, all tools, parts, equipment, supplies, materials, maps, plans and specifications, manuals, schedules, records, files, logs, work product, or property paid for, supplied or owned by the City will be returned to the City by the Contractor within one (1) business day.

## **3. ASSIGNMENT AND SUBCONTRACTING**

- A. Contractor will not assign or transfer this Agreement without the prior written approval of the City, as provided for in Ordinance 63687 approved in 1996. At least 90 days prior to any contemplated assignment of this Agreement, Contractor will submit a written request to the City along with a copy of the proposed assignment agreement. The City reserves the right to refuse without cause or justification, such requests. No assignment will be made or will be effective unless Contractor is not in default on any of the other terms, covenants, and conditions herein contained. The party to whom such assignment is made will expressly assume in writing the terms, covenants, and conditions of this Agreement. The parties to this Agreement understand and agree that the Contractor is and will remain responsible for the performance of its assigns under this Agreement. No assignment will be effective as it pertains to the City until such time as the City receives a fully executed copy of the approved assignment agreement as provided for above.



- B. Contractor will not subcontract or transfer any part of the services or work to be performed hereunder without the prior written approval of the Director of Airports. At least 60 days prior to any contemplated subcontracting of service or work or the transfer of any part of the services or work to be performed hereunder, Contractor will submit a written request to the Director of Airports. This request must include a copy of the proposed subcontract or agreement. The City reserves the right to refuse without cause or justification, such requests. At a minimum, any sub-contractor agreement must expressly require strict compliance with the terms, covenants, and conditions of this Agreement. The Contractor will furnish all authorized subcontractors or agents a copy of this Agreement. The parties understand and agree that the Contractor is responsible for the performance of its subcontractors or agents under this Agreement. No subcontract or any other agreement will be effective as it pertains to the City until such time as the City receives a fully executed copy of the approved subcontract or agreement as provided for above.
- C. Any such assignment or transfer or subcontracting of services without the consent of the City, as provided for above, will constitute default on the part of the Contractor under this Agreement. No action or failure to act on the part of any officer, agent, or employee of the City will constitute a waiver by the City of this provision.
- D. The City has approved the following M/W/DBE subcontractors for participation under this Agreement at the percentage participation goals as set out below:

<b>Above All Personnel</b>	<b>WBE</b>	<b>5%</b>
----------------------------	------------	-----------

#### 4. **AFFIRMATIVE ACTION PROGRAM AND NON-DISCRIMINATION**

- A. Contractor agrees during performance under this Agreement, that discrimination will not be permitted against any employee, worker, or applicant for employment because of race, creed, color, religion, sex, age, disability, national ancestry or origin.
- B. Contractor agrees during performance under this Agreement, that all printed or circulated solicitations, or other advertisement or publication for employees placed by or on behalf of the Contractor, state that all qualified applicants will receive meaningful consideration for employment without regard to race, creed, color, religion, sex, age, disability, national origin or ancestry.
- C. Contractor agrees during performance under this Agreement, that should it be determined by the Contractor or City that Contractor will be unable to conform to the approved positive employment program, submitted to determine eligibility under the Fair Employment Division Practices Provisions of the City Code, will notify the Fair Employment Division of the St. Louis Council on Human

Relations within ten days as to the steps to be taken by the Contractor to achieve the provisions of this program.

- D. Contractor will permit reasonable access by the City to such persons, reports and records as are necessary for the purpose of ascertaining compliance with fair employment practices.
- E. In the event of the Contractor's non-compliance with the nondiscrimination clauses of this Agreement, or to furnish information or permit records and accounts to be inspected, within twenty days from the date requested, this Agreement may be canceled, terminated, or suspended in whole or part and Contractor may be declared ineligible for further City contracts for a period of one year, by the option of the City; provided further in the event the contract is canceled, terminated, or suspended for failure to comply with fair employment practices, the Contractor will have no claim for any damages against the City.
- F. Contractor further agrees that these clauses (A through E) on discrimination and equal opportunity practices in all matters of employment and training for employment will be incorporated by Contractor in all contracts or agreements entered into with suppliers of materials or services, contractors and subcontractors and all labor organizations furnishing skilled, unskilled and craft union skilled labor, or who may perform any such labor or services in connection with this Agreement.
- G. Whenever the Contractor is sued or threatened with litigation by a subcontractor, vendor, individual, group or association, as a result of compliance with the clauses (A through F) of these provisions relating to fair employment practices, such contractor will notify the City Counselor in writing of such suit or threatened suit within ten days.
- H. The Contractor must submit evidence from the City's Civil Rights Enforcement Agency (**CREA**) stating that Contractor has complied with the City's requirements for an affirmative action program as required by the Mayor's Executive Order on Equal Opportunity in Employment.
- I. Contractor shall comply with all applicable nondiscriminatory requirements that may be imposed pursuant to the Federal Aviation Act of 1958, as amended; Title VI of the Civil Rights Act of 1964, as amended; 49 C.F.R. Parts 21, 23, and 26, as said regulations may be amended; and state and local laws.



5. **MINORITY BUSINESS ENTERPRISE AND WOMEN BUSINESS ENTERPRISE  
MBE/WBE) PARTICIPATION**

A. Definitions:

As used in this requirement, "Minority Business Enterprise" or "MBE" and "Women Business Enterprise" or "WBE" are defined as follows:

1. **"Minority Business Enterprise" or "MBE"** means a small business concern as defined in Small Business Act, 15 U.S.C., as amended that is 51 percent owned by a minority or, in the case of a corporation, at least 51 percent of the stock of which is owned by one or more individuals who are minorities; and whose management and daily business operations are controlled by one or more individuals who are Asian American, Black American, Hispanic American or Native American; and located in the Metropolitan St. Louis Area.
2. **"Women Business Enterprise" or "WBE"** means a small business concern as defined in the Small Business Act, 15 U.S.C., as amended that is 51 percent owned by a woman or, in the case of a corporation, at least 51 percent of the stock of which is owned by one or more women; and whose management and daily business operations are controlled by one or more individuals who are women; and located in the Metropolitan St. Louis Area.

B. Policy:

It is the policy of the City of St. Louis Airport Authority to ensure the maximum utilization of minority and women's business enterprises in contracting and the provision of goods and services to the City, its departments, agencies and authorized representative and to all entities receiving City funds or City-administered government funds while at the same time maintaining the quality of goods and services provided to the City and its subrecipients through the competitive bidding process. The provisions of this Policy will apply to all contracts awarded by the City, its departments and agencies and to all recipients of City funds or City-administered government funds and will be liberally construed for the accomplishments of its policies and purposes.

C. Goal:

A goal of 25 % MBE and 5 % WBE utilization has been established in connection with this Agreement. This goal is based on the original Agreement amount and remains in effect throughout the term of this Agreement. If an award of this Agreement is made and the MBE/WBE participation is less than this Agreement goal, the Contractor will continue good faith efforts throughout the term of this Agreement to increase MBE/WBE participation and to meet this Agreement goal.

**Please note: Contractors which have been certified as either an MBE or WBE are still required to fill both goals. In addition, Contractors which have been certified as an MBE and a WBE can only be used to fulfill either the MBE goal or the WBE goal, not both goals.**

D. Obligation:

1. The Contractor agrees to take all reasonable steps to ensure that MBEs/WBEs have maximum opportunity to participate in contracts and subcontracts financed by the City of St. Louis Airport Authority provided under this Agreement. The Contractor will not discriminate on the basis of race, color, national origin, or sex in the award or in the performance of contracts financed by the City of St. Louis Airport Authority.
2. A current Directory of M/W/DBE certified firms is available online at <http://www.flystl.com> under the M/WBE Directory link. A paper copy of the Directory may be requested at the Airport BDD Office, Lambert – St. Louis International Airport, P.O. Box 10212, St. Louis, Missouri 63145 or by calling (314) 426-8111.

E. Eligibility:

Contractor should contact the City of St. Louis Airport Authority BDD Office to obtain a list of eligible MBEs/WBEs and to determine the eligibility of the MBE/WBE firms it intends to utilize in this Agreement.

F. Counting MBE/WBE Participation Toward Goals:

MBE/WBE participation towards the attainment of the goal will be credited on the basis of the total subcontract prices agreed to between the Contractor and subcontractors for the contract items being sublet as reflected on the “**MBE/WBE Utilization Plan**”.

G. Post Award Compliance:

If the contract is awarded on less than full MBE/WBE goal participation, such award does not relieve the Contractor of the responsibility to continue good faith efforts to maximize participation of MBEs/WBEs during the term of this Agreement.

H. Substitution of MBE/WBE Firms After Award:

1. The Contractor will conform to the scheduled amount of MBE/WBE participation. When a listed MBE/WBE is unwilling or unable to perform the items of work or supply the goods or services specified in the MBE/WBE Utilization Plan, the Contractor will immediately notify the City of St. Louis Airport Authority BDD office prior to replacement of the firm.
2. Substitutions of MBE/WBE must be approved in writing by the Director. (See Appendix B, Section 3.B.) Substitutions of MBE/WBE will be allowed only when the MBE/WBE has failed to perform due to a default (material breach) of its subcontract or agreement. Contractor understands, warrants, and agrees that it will not cancel or terminate its agreement with the MBE/WBE without cause and will timely forward supporting documentation substantiating the cause of the default or termination to the Director for review.

I. Good Faith Efforts:

When the M/WBE goals cannot be met, the Contractor will document and submit justification utilizing the Contractor's **"Good Faith Efforts Report Form"** and provide a statement as to why the goals could not be met. The quality and intensity of the contractor's good faith efforts will be evaluated by the City. The Contractor must demonstrate the good faith efforts taken to meet the M/WBE goals, including but not limited to the following:

1. Efforts made to select portions of the work proposed to be performed by M/WBEs in order to increase the likelihood of achieving the stated goal, including, where appropriate, but not limited to, breaking down contracts into economically feasible units to facilitate M/WBE participation. Selection of portions of work are required to at least equal the goal for M/WBE utilization specified in the contract.
2. Written notification at least (14) calendar days prior to the opening of bids, soliciting individual M/WBEs interested in participation in the contract as a subcontractor, regular dealer, manufacturer, consultant, or service agency and for what specific items or type of work.
3. Written notification to disadvantaged economic development assistance agencies and organizations which provide assistance in recruitment and placement of M/WBEs, of the type of work, supplies, or services being considered for M/WBEs on this contract.
4. Efforts made to negotiate with M/WBEs for specific items of work including evidence on:

- a. The names, addresses, telephone numbers of M/WBEs who were contacted, the dates of initial contact and whether initial solicitations of interest were followed up by contacting the M/WBEs to determine with certainty whether the M/WBE is interested. Personal or phone contacts are expected.
  - b. A description of the information provided the M/WBEs regarding the plans and specifications and estimated quantities for portions of the work to be performed.
  - c. A statement of why additional agreements with M/WBEs were not reached, and
  - d. Documentation of each M/WBE contacted but rejected and the reasons for the rejection.
5. Absence of any agreements between the Contractor and the M/WBE in which M/WBE promises not to provide subcontracting quotations to other bidders.
6. Efforts made to assist the M/WBEs that need assistance in obtaining bonding, insurance, or lines of credit required by the Contractor.
7. Documentation that qualified M/WBEs are not available, or not interested.
8. Attendance at any meeting scheduled by the user department, or the St. Louis Development Corporation to encourage better Contractor-subcontractor relationships, forthcoming M/WBE utilization opportunities (i.e. pre-bid, workshops, seminars), etc.
9. Advertisement, in general circulation media, trade association publications, disadvantaged-focused media, of interest in utilizing M/WBEs and area of interest.
10. Efforts to effectively use the services of available disadvantaged community organizations; disadvantaged contractor's groups; local, state and federal disadvantaged business assistance offices; and other organizations that provide assistance in recruitment and placement of M/WBEs.
11. Examples of actions not acceptable as reasons for failure to meet the M/WBE goal.
  - a. M/WBE unable to provide performance and/or payment bonds.
  - b. Rejection of reasonable bid based on price.

- c. M/WBE would not agree to perform items of work at the unit bid price.
  - d. Union versus nonunion status.
  - e. Contractor normally would perform all or most of the work of the contract.
  - f. Solicitation by mail only.
  - g. Restricting to only those general group of items which may be listed in Bid under such headings "Items Subcontractible to M/WBE firms".
12. The demonstration of good faith efforts by the Contractor must, in the end, prove the Contractor had actively and aggressively sought out M/WBEs to participate in the project.
13. The information provided will be evaluated to determine if the low bidder is responsive. All the information provided must be accurate and complete in every detail. The apparent low bidder's attainment of the M/WBE goal or demonstration of good faith effort will assist in determining the award of the contract.

J. Record Keeping Requirements:

The Contractor will keep such records (copies of subcontracts, paid invoices, documentation of correspondence) as are necessary for the City of St. Louis Airport Authority to determine compliance with the MBE/WBE contract obligations. The City of St. Louis Airport Authority reserves the right to investigate, monitor and/or review actions, statements, and documents submitted by any contractor, subcontractor, or MBE/WBE.

K. Reporting Requirement:

The Contractor will submit quarterly reports on MBE/WBE involvement to the City of St. Louis Airport Authority BDD Office. Actual payments to MBEs/WBEs will be verified. These reports will be required until all MBE/WBE subcontracting activity is complete or the MBE/WBE goal has been achieved.

L. Applicability Of Provisions To MBE/WBE Contractors:

These provisions are applicable to all contractors including MBE/WBE contractors. If the MBE/WBE contractor intends to sublet any portion of this Agreement, the MBE/WBE contractor will comply with provisions regarding contractor and subcontractor relationships.

6. **RIGHT TO AUDIT CLAUSE**

- A. The Contractor's "**records**" must be open to inspection and subject to audit and reproduction during normal working hours and kept within the greater St. Louis metropolitan area. A City representative may perform such audits or an outside representative engaged by the City. The City or its designee may conduct such audits or inspections throughout the term of this Agreement, and for a period of three years after the early termination or the expiration of this Agreement or longer if required by law.
- B. The Contractor's "**records**" as referred to in this Agreement include any and all information, materials, and data of every kind and character, including without limitation, records, books, papers, documents, subscriptions, recordings, agreements, purchase orders, leases, contracts, communities, arrangements, notes, daily diaries superintendent reports, drawings, receipts, vouchers and memoranda, and any and all other agreements, sources of information and matters that may in City's judgment have any bearing on or pertain to any matters, rights, duties or obligations under or covered by this Agreement. Such records subject to audit also include, but are not limited to, those records necessary to evaluate and verify direct and indirect costs, (including overhead allocations) as they may apply to costs associated with this Agreement. Such records include (hard copy, as well as computer readable data if reasonably available), written policies and procedures; time sheets; payroll registers; cancelled checks; original estimates; estimating work sheets; correspondence; change order files (including documentation covering negotiated settlements); backcharge logs and supporting documentation; general ledger entries detailing cash and trade discounts earned, insurance rebates and dividends; and any other Contractor records which may have a bearing on matters of interest to the City in connection with the Contractor's work for the City (all foregoing hereinafter referred to as "records") to the extent necessary to adequately permit evaluation of:
1. Contractor's compliance with the Provisions of this Agreement or the performance of the services contemplated herein; or
  2. Compliance with provisions for pricing, change orders, invoices or claims submitted by the Contractor or any of its payees or subcontractors, if any.

7. **NOTICE PROVISION**

Except as herein otherwise expressly provided, all notices required to be given to the City hereunder must be in writing and must be delivered personally or be sent by certified mail return receipt requested, or overnight courier to:

Rhonda Hamm Niebruegge  
Airport Director  
St. Louis Airport Authority  
P.O. Box 10212  
St. Louis, MO 63145

With a copy to:

Ron Stella  
St. Louis Airport Authority  
P.O. Box 10212  
St. Louis, MO 63145

And a copy to:

Robert Salarano  
St. Louis Airport Authority  
P.O. Box 10212  
St. Louis, MO 63145

All notices, demands, and requests by the City to the Contractor must be sent to:

Marvin Storer  
Rentokil North America, Inc. d/b/a Ambius  
3952 Clayton Avenue  
St. Louis, Missouri 63110

The City or Contractor may designate in writing from time to time any changes in addresses or any addresses of substitutes or supplementary persons in connection with said notices. The effective date of service of any such notice shall be deemed received at the earlier of actual receipt or the dates such notice is mailed to the Contractor or the Airport Director.

**CITY OF ST. LOUIS  
LAMBERT - ST. LOUIS INTERNATIONAL AIRPORT®**

**APPENDIX "C"  
RATES FOR INTERIOR LIVE PLANT MAINTENANCE SERVICES**

*Year 1*

	Bid Item*
Monthly Rate (Includes Color Rotation Program)	\$2,128.00 Per Month
Monthly Rate For Scent Machines (Includes Scenting & Machine Maintenance)	\$ 190.00 Per Month
Hourly Labor Rate (For Extra Work Only)	\$ 0.00 Per Hour

*Year 2*

	Bid Item*
Monthly Rate (Includes Color Rotation Program)	\$2,170.56 Per Month
Monthly Rate For Scent Machines (Includes Scenting & Machine Maintenance)	\$ 190.00 Per Month
Hourly Labor Rate (For Extra Work Only)	\$ 0.00 Per Hour

*Year 3*

	Bid Item*
Monthly Rate (Includes Color Rotation Program)	\$2,213.97 Per Month
Monthly Rate For Scent Machines (Includes Scenting & Machine Maintenance)	\$ 190.00 Per Month
Hourly Labor Rate (For Extra Work Only)	\$ 0.00 Per Hour



IN WITNESS WHEREOF, the parties have hereunto affixed their hands and seals as set forth below:

RENTOKIL NORTH AMERICA, INC.  
D/B/A AMBIUS

ATTEST:

BY: [Signature] 1/21/16  
Date

BY: RR- 1/21/16  
Date

THE CITY OF ST. LOUIS, MISSOURI, OWNER AND OPERATOR OF  
LAMBERT-ST. LOUIS INTERNATIONAL AIRPORT:

The foregoing Agreement was approved on this \_\_\_\_\_ day of \_\_\_\_\_, 2016,  
by the Airport Commission.

BY: [Signature] 2/3/16  
Director of Airports Date

The foregoing Agreement was approved by the Board of Estimate and Apportionment at its  
meeting on February 17, 2016.

BY: [Signature] 2/17/16  
Secretary Date  
Board of Estimate & Apportionment

APPROVED AS TO FORM BY:

COUNTERSIGNED BY:

[Signature] 2-4-16  
City Counselor Date

[Signature]  
Comptroller Date

ATTESTED TO BY:

[Signature] MAR 10 2016  
Register Date

COMPTROLLER'S OFFICE  
DOCUMENT NUMBER 69649

**Exhibit A**  
**Affidavit**  
**(Missouri Unauthorized Aliens Law)**

Confidential  
garvinm@stlouis-mo.gov  
2020-01-16 13:35:37 +0000

STATE OF Pennsylvania )  
COUNTY OF Berks ) ss.

**AFFIDAVIT**

Before me, the undersigned Notary Public, personally appeared VICKI FISHER (Name of Affiant) who, by me being duly sworn, deposed as follows:

My name is VICKI FISHER (Name of Affiant), I am of sound mind, capable of making this Affidavit, and personally acquainted with the facts herein stated:

I am the DIRECTOR HR SERVICES (Position/Title) of RENTOKIL NORTH AMERICA (Contractor).

I have the legal authority to make the following assertions:

1. RENTOKIL NORTH AMERICA (Contractor) is currently enrolled in and actively participates in a federal work authorization program with respect to the employees working in connection with AMBIUS PROJECT AT (the "Agreement"), as required pursuant to Sections 285.525 through 285.555 of the Revised Statutes of Missouri 2000, as amended.
2. Pursuant to Sections 285.525 through 285.555 of the Revised Statutes of Missouri 2000, as amended, RENTOKIL NORTH AMERICA (Contractor) does not knowingly employ any person who is an unauthorized alien in connection with the Agreement.

Vicki Fisher  
Affiant

IN WITNESS WHEREOF, I have hereunto subscribed my name and affixed my official seal this 28 day of OCT, 2015

My Commission Expires:

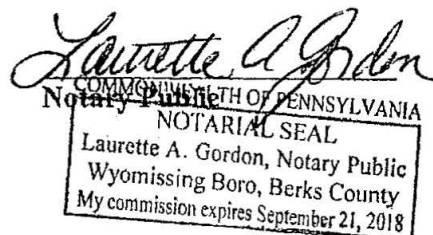

**Exhibit B**

**Plant Maintenance Agreement Inventory**

Confidential  
garvinm@stlouis-mo.gov  
2020-01-16 13:35:37 +0000

# Plant Maintenance Agreement Inventory

LOCATION	VARIETY		QUANTITY	POT SIZE INCHES	NOTES
Terminal 1 Lower Level				Inches	
Police Station	Hanging Baskets Mixed Plants		5	30	
Baggage	Sansevaria laurentii	Mother-in-Law tongue	6	10	
Chapel	Aglaonema hybrid	Chinese Evergreen	3	10	
Chapel	Aglaonema 'Emerald Beauty'	Chinese Evergreen	2	8	
Lambert Gallery/Chapel	Dracaena fragrans massangeana	Corn Plant	1	14	
Lambert Gallery	Rhapis excelsa	Rhapis Palm	1	14	
Lambert Gallery	Dracaena marginata	Dragon Tree	2	10	
Lambert Gallery	Aglaonema hybrid	Chinese Evergreen	14	6	
Lambert Gallery	Aglaonema 'Cutless'	Chinese Evergreen	3	10	
Lambert Gallery	Pothos 'Neon'	Philodendron	8	6	
Lambert Gallery	Color Program	Bromeliad	15	6	
MTS-2720C	Aglaonema 'Cutless'	Chinese Evergreen	1	8	
MTS-2720C	Pothos 'Neon'	Philodendron	2	8	
Women's Restroom MTS-2720C	Aglaonema 'Emerald Beauty'	Chinese Evergreen	1	8	
Women's Restroom MTN-2084PC	Aglaonema 'Emerald Beauty'	Chinese Evergreen	1	8	
Information Desk/Paging	Aglaonema 'Emerald Beauty'	Chinese Evergreen	2	8	
Information Desk/Paging	Color Program	Bromeliad	3	6	
US Bank	Color Program	Bromeliad	3	6	
Starbucks	Color Program	Bromeliad	3	6	
Starbucks	Philodendron 'Zanadu'	Philodendron	1	10	
Pasta House	Color Program	Bromeliad	6	6	
Elevator	Aglaonema 'Silver Bay'	Chinese Evergreen	1	14	
Escalator	Sansevaria zeylanica	Mother-in-Law tongue	1	14	
Human Resources	Philodendron 'Zanadu'	Philodendron	2	14	
Freedom Shrine	Aglaonema 'Cutless'	Chinese Evergreen	2	10	
Lambert Art Culture	Aglaonema 'Silver Bay'	Chinese Evergreen	2	10	
Seating	Dracaena marginata	Dragon Tree	1	14	
Women's Restroom MTN-2292	Aglaonema 'Emerald Beauty'	Chinese Evergreen	3	8	
Outside Administration Top of Ramp	Color Program	Bromeliad	6	6	
Outside Administration Office/A	Dracaena fragrans massangeana	Corn Plant	1	10	
Outside Administration Office/A	Color Program	Bromeliad	6	6	
Outside Administration Office/A	Pothos 'Neon'	Philodendron	4	6	
Administration Office	Aglaonema 'Silver Bay'	Chinese Evergreen	3	14	
Administration Office	Aglaonema 'Cutless'	Chinese Evergreen	2	10	
Administration Office	Dracaena deremensis 'Lisa'	Lisa Cane	2	10	
Administration Office	Sansevaria zeylanica	Mother-in-Law tongue	2	14	
Administration Office	Sansevaria zeylanica	Mother-in-Law tongue	1	10	
Administration Office	Pothos 'Marble Queen'	Philodendron	1	8	
Airport Properties	Aglaonema 'Silver Queen'	Chinese Evergreen	2	6	
Women's Restroom A-2	Aglaonema 'Emerald Beauty'	Chinese Evergreen	1	8	
Women's Restroom A-8	Aglaonema 'Emerald Beauty'	Chinese Evergreen	1	8	
Women's Restroom A-16	Aglaonema 'Emerald Beauty'	Chinese Evergreen	1	8	
Women's Restroom C-24	Aglaonema 'Emerald Beauty'	Chinese Evergreen	1	8	
Family Assist Restroom C-15	Aglaonema 'Emerald Beauty'	Chinese Evergreen	1	8	
Women's Restroom C-15	Aglaonema 'Emerald Beauty'	Chinese Evergreen	1	8	
Women's Restroom C-9	Aglaonema 'Emerald Beauty'	Chinese Evergreen	1	8	
Women's Restroom C-2	Aglaonema 'Emerald Beauty'	Chinese Evergreen	1	8	
D Concourse Entrance	Schefflera arboricola	Arboricola Column	2	14	
Business Diversity	Aglaonema 'Silver Bay'	Chinese Evergreen	6	14	

# Plant Maintenance Agreement Inventory

<b>Terminal 1 Upper Level</b>					
Metrolink Hallway	Schefflera arboricola	Hawaiian Schefflera	8	10	
Lindberg Conference Room	Dracaena 'Janet Craig Compacta'	Janet Craig Cane	4	10	
Lindberg Conference Room	Pothos hybrid 'Joy'	Philodendron	4	8	
MT2	Philodendron 'Red Congo'	Philodendron	2	14	
MT2 womens restroom	Aglaonema 'Emerald Beauty'	Chinese Evergreen	1	8	
Spirit Room Balcony	Dracaena deremensis 'Janet Craig'	Janet Craig Cane	1	14	
Spirit Room Balcony	Aglaonema 'Silver Queen'	Chinese Evergreen	1	14	
Spirit Room Balcony	Aglaonema 'Emerald Beauty'	Chinese Evergreen	1	10	
Spirit Room Balcony	Aglaonema 'Cutless'	Chinese Evergreen	6	10	
Spirit Room Balcony	Dracaena deremensis 'Goldstar'	Dracaena Cane	6	14	
Spirit Room Balcony	Color Program	Bromeliad	3	6	
MT3	Dracaena marginata	Dragon Tree	2	14	
MT3	Color Program	Bromeliad	8	6	
Seating Area	Ficus benjamina	Ficus	3	14	
Seating Area	Color Program	Bromeliad	4	6	
MT4 Escalator	Pothos 'Jade'	Philodendron	4	6	
MT4 Escalator	Color Program	Bromeliad	8	6	
MT4	Schefflera arboricola	Arboricola Column	1	14	
MT4	Rhapis excelsa	Rhapis Palm	1	14	
Living Wall	Assorted Plant Varieties		592	4	
Living Wall	Beaucarnea recurvata	Ponytail Palm	6	8	
Living Wall	Ficus benjamina	Ficus	4	14	
MT5 Elevator	Color Program	Bromeliad	2	6	
MT5 Elevator	Pothos 'Jade'	Philodendron	2	8	
MT5	Schefflera arboricola	Arboricola Column	2	14	
UA Escalator	Color Program	Bromeliad	2	6	
UA Escalator	Pothos 'Jade'	Philodendron	2	8	
UA Seating	Ficus benjamina	Ficus	3	14	
MT6	Philodendron 'Zanadu'	Philodendron	2	14	
MT6	Color Program	Bromeliad	4	6	
<b>LOCATION</b>	<b>VARIETY</b>		<b>QUANTITY</b>	<b>POT SIZE</b>	
<b>Terminal 2 Lower Level</b>					
Exit 11	Schefflera arboricola	Arboricola Column	2	14	
Exit 11	Sansavaria laurentii	Mother-in-Law tongue	3	10	
Exit 12-14	Color Program	Kalanchoe/Mum	19	6	
Exit 12-14	Zamioculcas zamiifolia	ZZ Plant	3	10	
Exit 14	Color Program	Kalanchoe/Mum	10	6	
Exit 14/Baggage	Schefflera arboricola	Arboricola Column	6	10	
Exit 14/Baggage	Ficus 'Alii'	Ficus	2	14	
Exit 14/Baggage	Ficus 'Alii'	Ficus	1	14	
Escalator	Ficus 'Alii'	Ficus	2	14	
Escalator	Sansavaria zelonica	Mother-in-Law tongue	2	10	
Escalator	Color Program	Kalanchoe/Mum	5	6	
Escalator	Rhapis excelsa	Rhapis Palm	3	14	
<b>Terminal 2 Upper Level</b>					
Exit 2-3 window	Sansavaria zelonica	Mother-in-Law tongue	3	10	
Exit 2-3 window	Color Program	Kalanchoe/Mum	10	6	
Exit 3	Rhapis excelsa	Rhapis Palm	1	14	
Starbucks	Brassaia actinophylla	Schefflera 'Amate'	1	14	
Gate 29-33	Schefflera arboricola	Arboricola Column	1	10	
Gate 29-33	Dracaena deremensis 'Lisa'	Lisa Cane	2	10	
Gate 29-33	Schefflera arboricola	Arboricola Column	1	10	
Gate 29-33	Dracaena deremensis 'Rikki'	Rikki Cane	1	10	
Gate 29-33	Aglaonema 'Emerald Beauty'	Chinese Evergreen	1	14	
Gate 29-33	Dracaena deremensis 'Janet Craig'	Janet Craig Cane	2	14	
Gate 29-33	Sansevieria laurentii	Mother-in-Law tongue	1	10	
Gate 29-33	Aglaonema hybrid	Chinese Evergreen	1	14	

# Plant Maintenance Agreement Inventory

Gate 29-33	Schefflera arboricola	Hawaiian Schefflera	3	14	
Food Court - Baskin Robins	Dracaena fragrans massangeana	Corn Plant	1	14	
Food Court - Inmotion	Aglaonema 'Emerald Beauty'	Chinese Evergreen	3	10	
Food Court - Inmotion	Sanseviaria laurentii	Mother-in-Law tongue	2	10	
Customs Terminal	Strelitzia nicolai	White Bird of Paradise	6	14	
Customs Terminal	Color Program	Kalanchoe/Mum	16	6	
Scenting Units	Terminal 1 Ticketing				
	Terminal 2 Security				
		Total Plants	944		

Confidential  
garvinm@stlouis-mo.gov  
2020-01-16 13:35:37 +0000



**Exhibit C**

**Color Rotation Program**

Confidential  
garvinm@stlouis-mo.gov  
2020-01-16 13:35:37 +0000

**Terminal 1**

Lambert Gallery

Information Desk/Paging

US Bank

Starbucks

Pasta House

Outside Administration Top of Ramp

Outside Administration Office/A

Spirit Room Balcony

MT3

Seating Area

MT4 Escalator

MT5 Elevator

UA Escalator

MT6

**Total Color Program Postions at Terminal 1**

**73**

all are in a 6" pot

Bromiliads changed out eight times in 48 weeks

One installation of Poinsettia for 4 weeks for  
a total of 52 weeks

# Color Rotation Program

Terminal 2	Rotation Schedule Weeks
Azalea	2
Azalea	2
Kalanchoe	3
Cyclamen	2
Cyclamen	2
Chrysanthumum	2
Chrysanthumum	2
Kalanchoe	3
Kalanchoe	3
Kalanchoe	3
Bromeliad	7
Kalanchoe	3
Kalanchoe	3
Kalanchoe	3
Chrysanthumum	2
Chrysanthumum	2
Chrysanthumum	2
Chrysanthumum	2
Poinsettia	4
Total of 52 weeks	
<b>Total Color Program <u>Positions</u> At Terminal 2</b>	<b>60</b>
All are a 6" pot	

**Attachment 1**

**Maps**

Confidential  
garvinm@stlouis-mo.gov  
2020-01-16 13:35:37 +0000

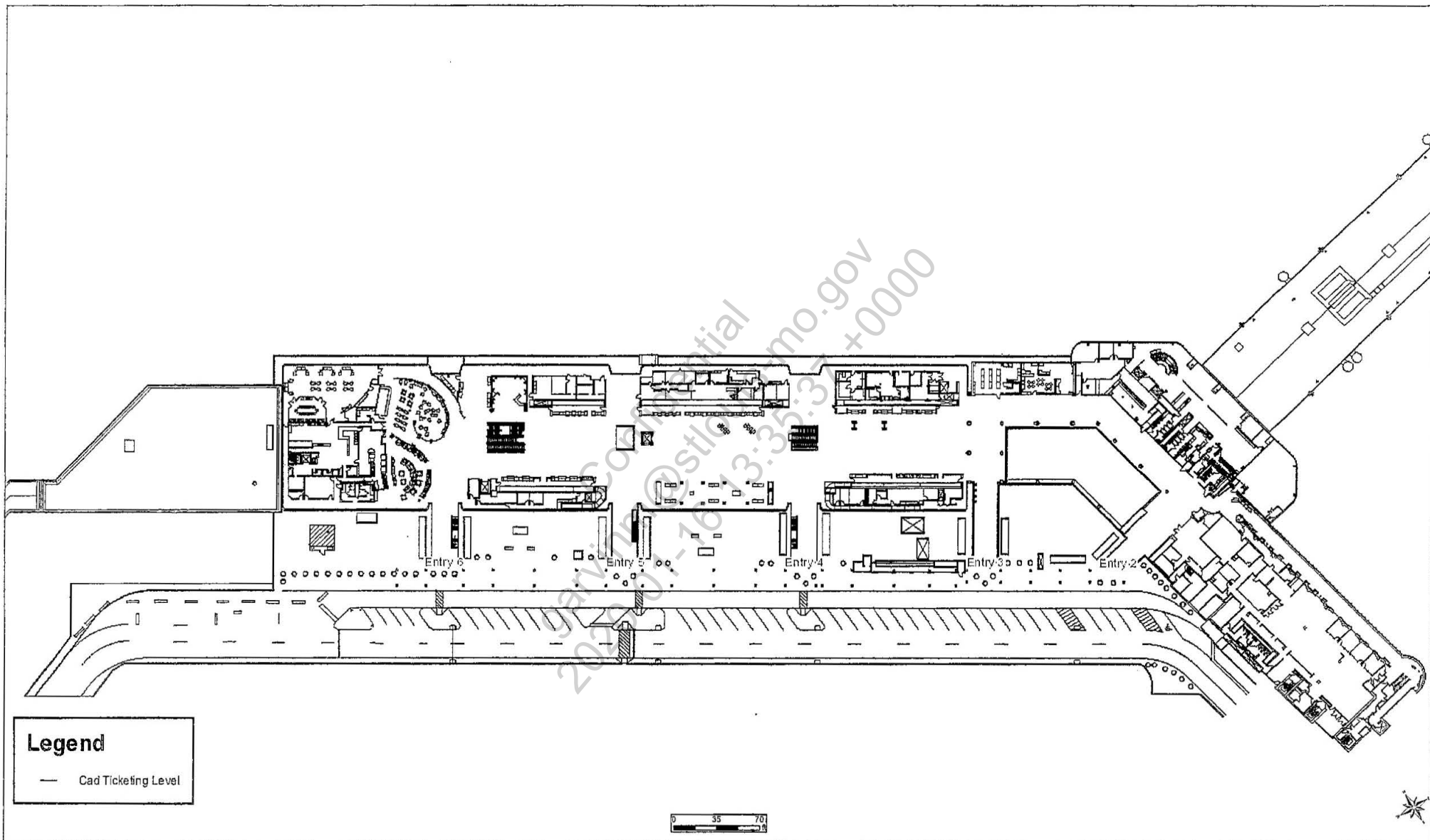

# Legend

— Cad Ticketing Level

0 35 70

## Terminal 1 Ticketing Level Terminal

This document and its contents are controlled by Lambert-St. Louis International Airport. The reproduction or dissemination of this document or any part thereof, by any means, is prohibited without the written permission of the Lambert-St. Louis International Airport. The information contained on this document has been compiled from multiple sources, and the Lambert-St. Louis International Airport does not make any warranty as to its representation or accuracy. The information is represented or implied on this document is the property of the Lambert-St. Louis International Airport.

**Coordinate System:**  
State Plane Coordinate, Missouri East Zone  
North American Datum 1983 Survey Feet

Prepared By: ST/LAA  
Date: 9/18/2015  
Review and Approval By:  
Date:

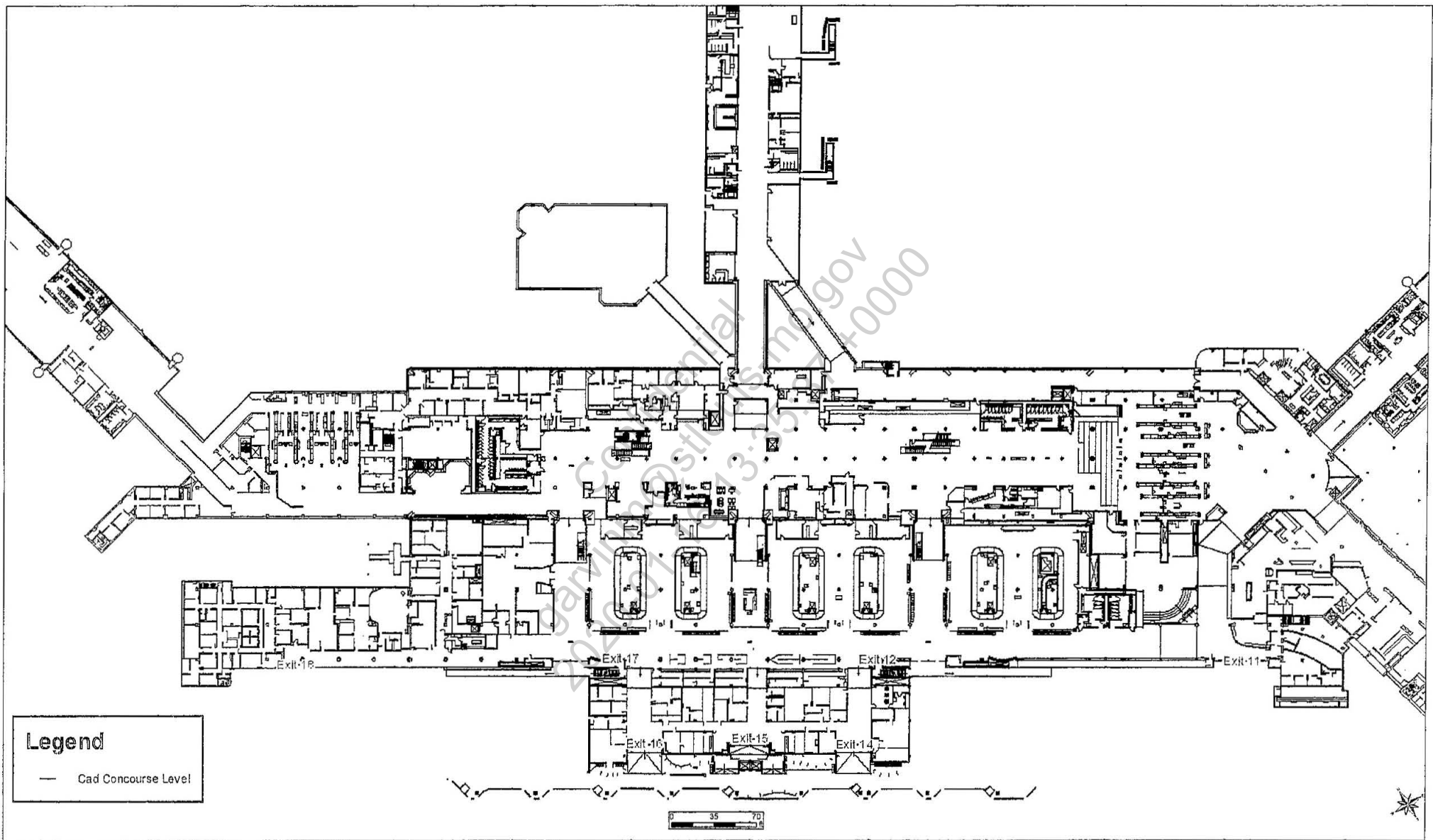

# Terminal 1 Baggage Claim Level Terminal

This document and its contents are the property of Lambert-St. Louis International Airport. The reproduction or dissemination of this document or any part thereof, by any process, is prohibited without the written permission of the Lambert-St. Louis International Airport. The information contained on this document has been compiled from multiple sources, and the Lambert-St. Louis International Airport does not make any warranty as to the accuracy or accuracy. The information is represented as is on this document is the property of the Lambert-St. Louis International Airport.

**Coordinate System:**  
State Plane Coordinate, Missouri East Zone  
North American Datum 1983 Survey Feet

Prepared By: STLAA  
Date: 9/18/2015  
Review and Approval By:  
Date:

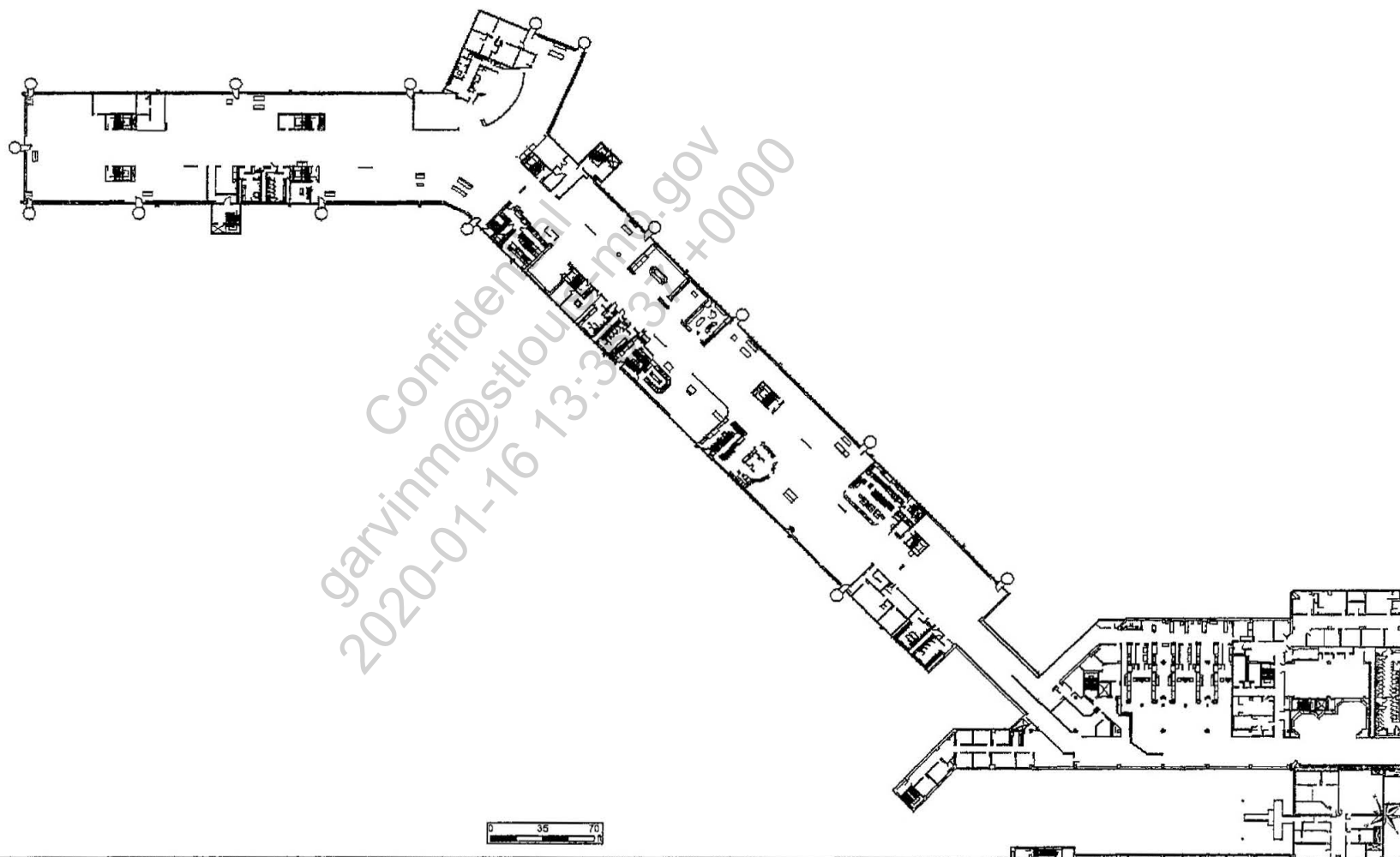

**Legend**

— Cad Concourse Level

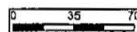

**Terminal 1 A Concourse**  
**Terminal**

This document and its intended use is controlled by Lambert-St. Louis International Airport. The reproduction or dissemination of this document, or any part thereof, in any process, is prohibited without the written permission of the Lambert-St. Louis International Airport. The information contained in this document has been compiled from multiple sources, and the Lambert-St. Louis International Airport does not make any warranty as to its representation or accuracy. The information contained in this document is the property of the Lambert-St. Louis International Airport.

**Coordinate System:**  
State Plane Coordinate, Missouri East Zone  
North American Datum 1983 Survey Feet

Prepared By: STLAA  
Date: 9/18/2015  
Review and Approval By:  
Date:



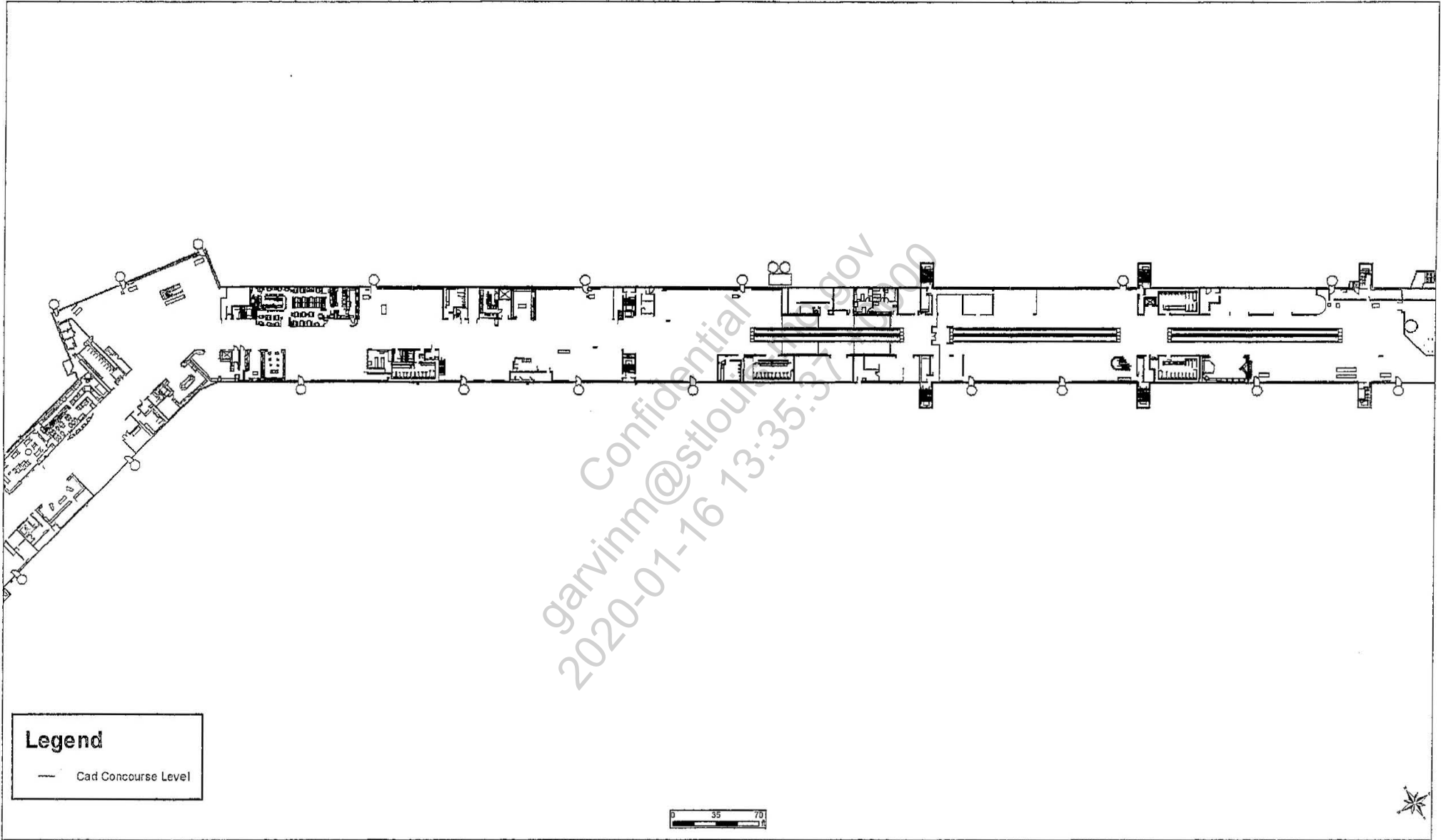

	<b>Terminal 1 C Concourse (continuation)</b> <b>Terminal</b>	<small>This document and its contents are the property of Lambert-St. Louis International Airport. The reproduction or dissemination of this document, or any part thereof, by any person, is prohibited without the written permission of the Lambert-St. Louis International Airport. The information contained in this document has been compiled from multiple sources, and the Lambert-St. Louis International Airport does not make any warranty as to the accuracy or reliability of the information contained in this document on the property of the Lambert-St. Louis International Airport.</small>	<b>Coordinate System:</b> State Plane Coordinate, Missouri East Zone North American Datum 1983 Survey Feet	Prepared By: SYLAA Date: 9/18/2015 Review and Approval By: Date:
--	---	--	--	---

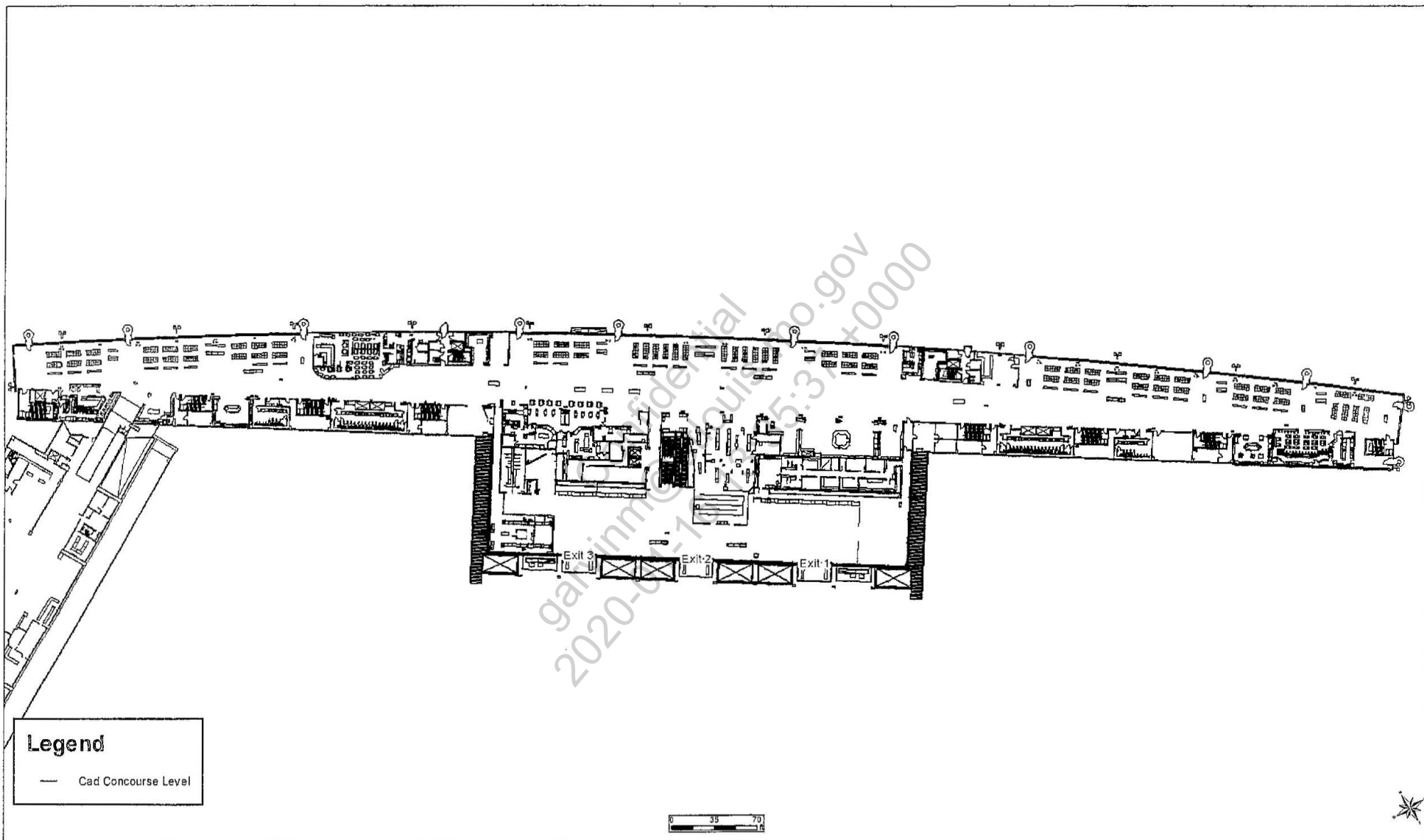

<p>Terminal 2 Ticketing and Gates</p> <p>Terminal</p>	<p>Terminal 2 Ticketing and Gates</p> <p>Terminal</p>	<p>This document and its contents are the property of the Missouri State Department of Transportation. It is to be used for the purpose of the project for which it was prepared and is not to be distributed, copied, or reproduced in any form without the written permission of the Missouri State Department of Transportation. The information contained on this document has been compiled from multiple sources, and the Missouri State Department of Transportation does not make any warranty as to its representation or accuracy. The information represented or implied on this document is the property of the Missouri State Department of Transportation.</p>	<p><b>Coordinate System:</b></p> <p>State Plane Coordinate, Missouri East Zone</p> <p>North American Datum 1983 Survey Feet</p>	<p>Prepared By: STLAA</p> <p>Date: 8/18/2015</p> <p>Review and Approval By:</p> <p>Date:</p>
---	---	--	---	--

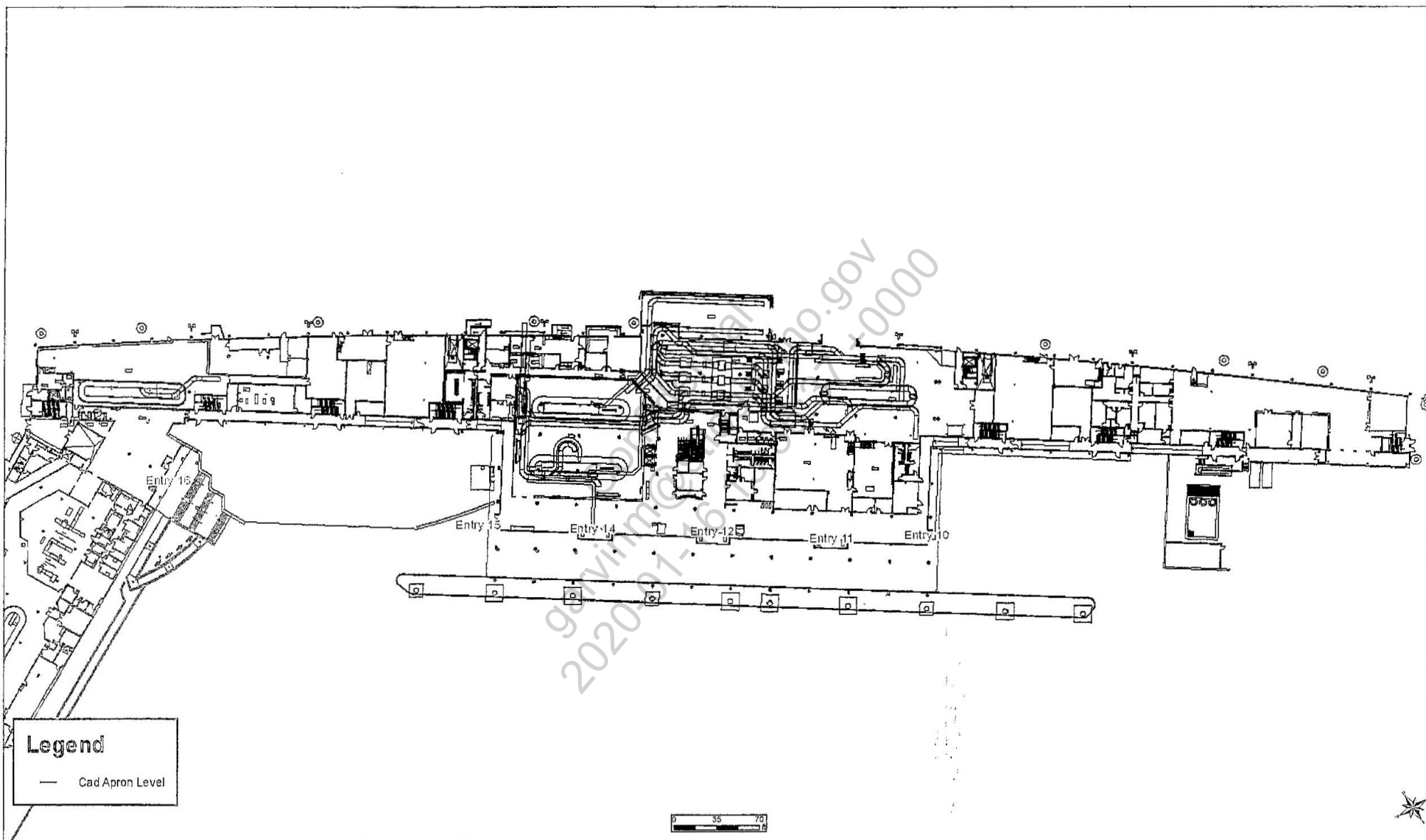

	<b>Terminal 2 Baggage Claim Level</b> <b>Terminal</b>	<small>This document is intended for internal use only and is controlled by Lambert-St. Louis International Airport. The reproduction or dissemination of this document or any part thereof, by any process, is prohibited without the written permission of the Lambert-St. Louis International Airport. The information contained on this document has been compiled from multiple sources, and the Lambert-St. Louis International Airport does not make any warranty as to the accuracy or completeness of the information. The information is provided as a service to the public and is not to be used for any other purpose.</small>	<b>Coordinate System:</b> State Plane Coordinate, Missouri East Zone North American Datum 1983 Survey Feet	Prepared By: STLAA Date: 9/18/2015 Review and Approval By: Date:
--	--	---	--	---

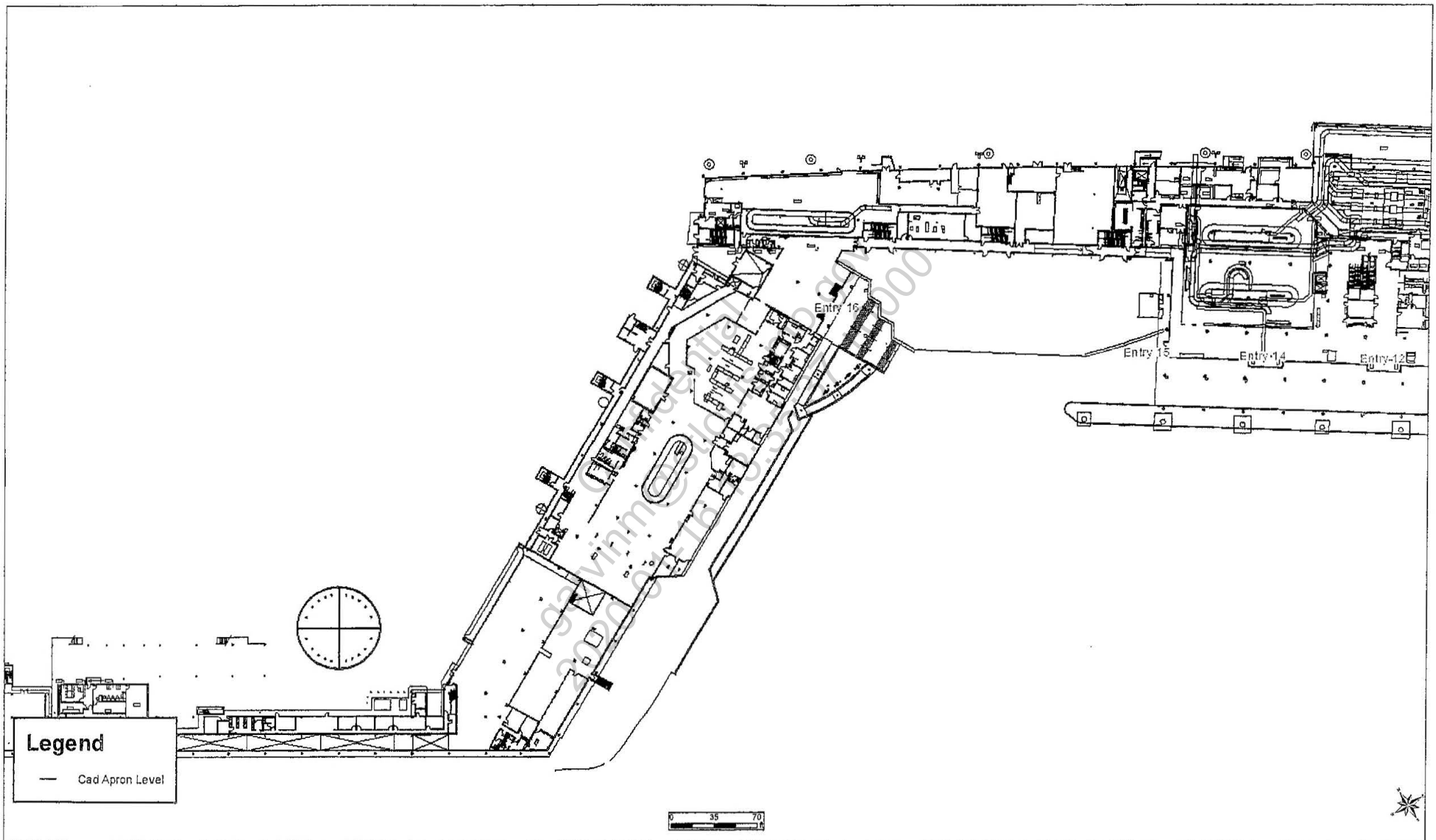

## Terminal 2 Customs and Lobby Terminal

This document and its contents are the property of the Lambert-St. Louis International Airport. The reproduction or dissemination of this document, in any form, by any person, is prohibited without the written permission of the Lambert-St. Louis International Airport. The information contained on this document has been compiled from multiple sources, and the Lambert-St. Louis International Airport does not make any warranty as to the representation or accuracy. The information is provided as a reference only and should not be used for any other purpose.

**Coordinate System:**  
State Plane Coordinate, Missouri East Zone  
North American Datum 1983 Survey Feet

Prepared By: STCAA  
Date: 8/18/2015  
Review and Approval By:  
Date: