

See Plan Detail

Legend		
Existing	Future	Description
---	---	Airport Property Line
P77	P77	FAR Part 77 Surface
TSS	TSS	Threshold Sling Surface
TERPS	TERPS	TERPS Visual Surface
DEP	DEP	Departure Surface
PAPI	PAPI	Precision Approach Slope Indicator Surface (PAPI)
VGS	VGS	TERPS VGS Surface
---	---	Approach Runway Protection Zone (RPZ)
---	---	Departure Runway Protection Zone (RPZ)
---	---	Airfield Pavement
---	---	Paved Shoulder
---	---	Airport Service Road
---	---	Airfield Pavement Removal
---	---	Airport Buildings
---	---	Houses And Outbuildings
---	---	Aviation Easement
---	---	Building Restriction Line (BRL)
---	---	Runway Safety Area (RSA)
---	---	Runway Object Free Area (ROFA)
---	---	Obstacle Free Zone (OFZ)
---	---	Precision Obstacle Free Zone (POFZ)
---	---	ILS-Glide Slope Antenna & Critical Area
---	---	Threshold Lights
---	---	Low Level Windshear Alert System (LLWAS)
---	---	Precision Runway Monitor
---	---	Airport Rotating Beacon
---	---	Wind Cone
---	---	Wind Cone And Segmented Circle
---	---	Remote Unit ASDE
---	---	Airport Surveillance Radar (ASR)
---	---	Automated Weather Observation System (AWOS)
---	---	Distance Measuring Equipment (DME)
---	---	Precision Approach Path Indicator (PAPI)
---	---	Ground Contours
---	---	N/A
---	---	Lakes Ponds Or Streams
---	---	Fence
---	---	Man Made Structure Elevation Point (Plan View / Profile View)

- General Notes**
- 1.) Base Map was developed using aerial photo and photogrammetric mapping dated June 2020.
 - 2.) Obstacles identified from aerial mapping, collected in accordance with AC 150/500-108 standards are numbered starting with "1001" according to the GIS database created for the FAA GIS.
 - 3.) Road elevations are estimated and include an additional 10-foot (3.05m) adjustment for service roads/public roads/states/roads, respectively.
 - 4.) The inner approach surface is depicted to a height of 100' above the runway end elevation. See the Airport Airspace Drawing for a complete depiction of Part 77 surfaces.
 - 5.) Objects with 50' or greater clearance of all Surfaces have not been depicted.
 - 6.) Trees within 15' of all Surfaces, are identified for planning purposes.
 - 7.) Runway obstruction table shown on Runway Obstruction Table sheets.
 - 8.) Future development and/or land uses identified will be implemented in accordance with airspace requirements applicable at that time. No new man-made obstructions will be created which impact approach capabilities to the runway.

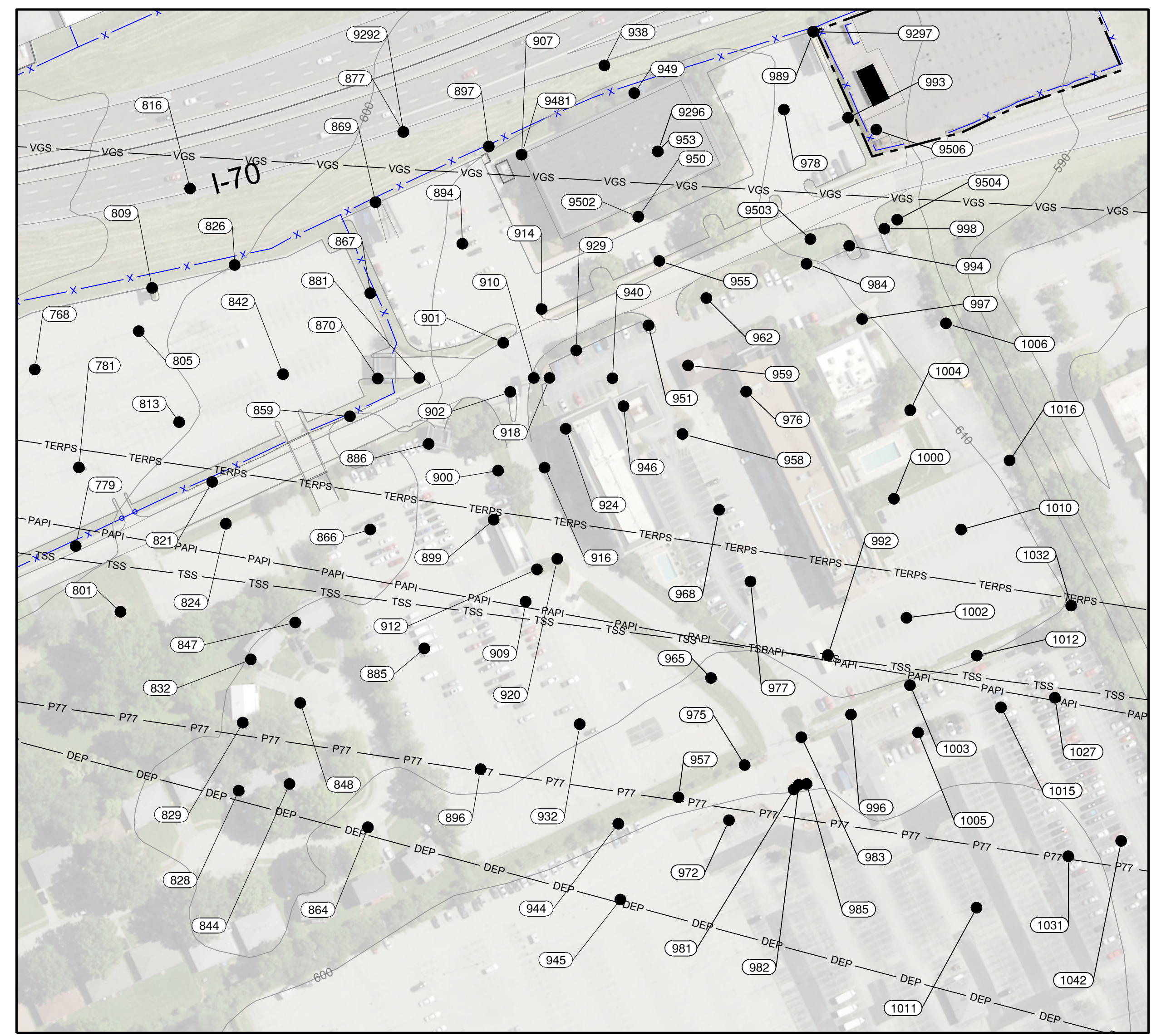
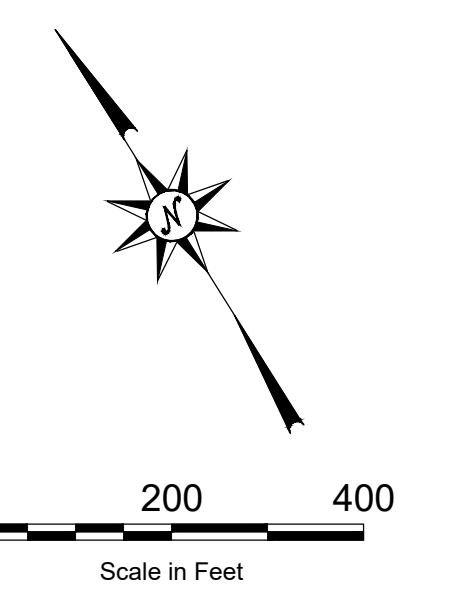

Plan Detail
Scale 1"=100'

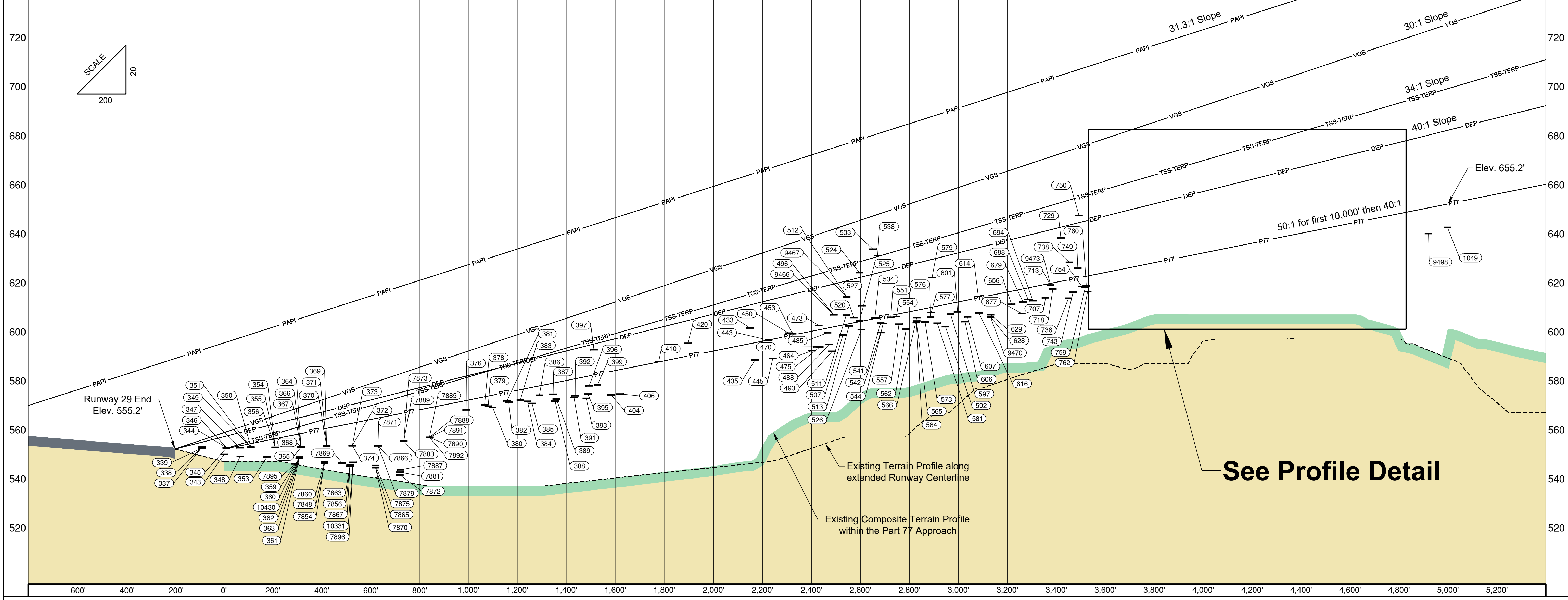

See Profile Detail

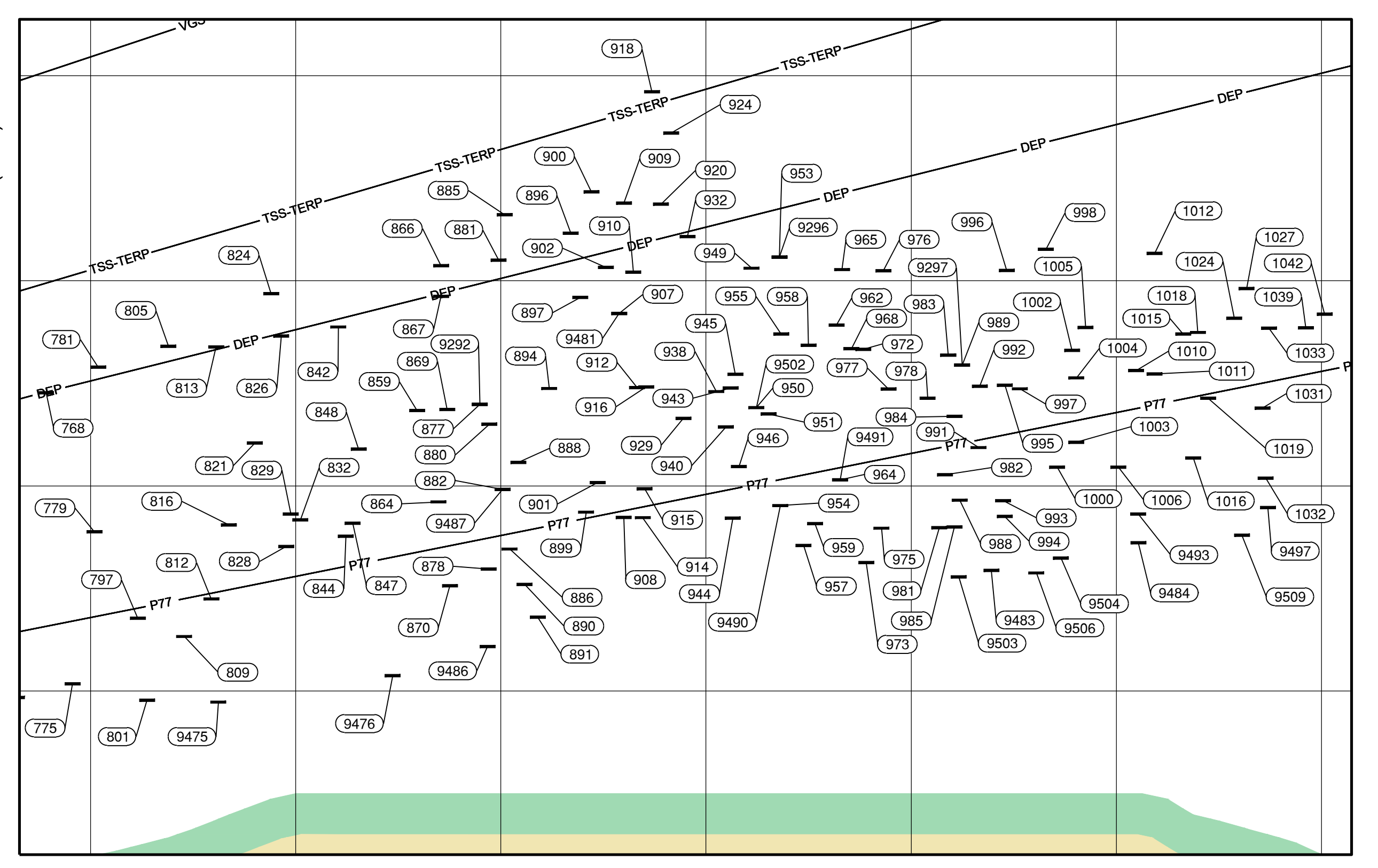

Profile Detail
Scale 1"=100'

Lineal Feet Beyond Start of Approach Surface | Lineal Feet Before Start of Approach Surface